



Basic Details

Organisation Chain	Uttar Pradesh Metro Rail Corporation Limited Contract Cell - UPMRCL		
Tender Reference Number	LKRS-02		
Tender ID	2026_UPMRC_276284_1	Withdrawal Allowed	Yes
Tender Type	Open Tender	Form of contract	Works
Tender Category	Works	No. of Covers	2
General Technical Evaluation Allowed	No	ItemWise Technical Evaluation Allowed	No
Payment Mode	Offline	Is Multi Currency Allowed For BOQ	Yes
Is Multi Currency Allowed For Fee	No	Allow Two Stage Bidding	No

Payment Instruments

Offline	S.No	Instrument Type
	1	Demand Draft
	2	FDR
	3	Bankers Cheque
	4	Bank Guarantee
	5	NEFT
	6	R-T-G-S

Cover Details, No. Of Covers - 2

Cover No	Cover	Document Type	Description
1	Fee/PreQual/Technical	.pdf	Scanned Copy of payment transaction for Tender Fee and EMD
		.pdf	Technical Package and other supporting Documents
2	Finance	.xls	Bill of Quantity

Tender Fee Details, [Total Fee in ₹ * - 23,600]

Tender Fee in ₹	23,600	Fee Payable To	UPMRCL (Lucknow Project)	Fee Payable At	LUCKNOW
Tender Fee Exemption Allowed	Yes				

EMD Fee Details

EMD Amount in ₹	6,70,00,000	EMD Exemption Allowed	Yes
EMD Fee Type	fixed	EMD Percentage	NA
EMD Payable To	UPMRCL (Lucknow Project)	EMD Payable At	LUCKNOW

Foreign Currency BOQ Details

S.No	Currency	Conversion rate in ₹
1	US Dollar	NA
2	European Euro	NA
3	British Pound	NA
4	Australian Dollar	NA
5	Egypt Pound	NA
6	Japanese yen	NA
7	Swiss Franc	NA
8	Canadian Dollar	NA
9	Norwegian Kroner	NA
10	Singapore Dollar	NA
11	Russian Ruble	NA
12	Swedish Krona	NA
13	South African Rand	NA
14	Belarusian Ruble	NA
15	China Yuan	NA

Work /Item(s)

Title	Design, Manufacture, Supply, Testing, Commissioning and Training of 45 Nos. Standard Gauge Cars including Signalling and Train Control System for Lucknow Metro Phase 1B Project				
Work Description	Design, Manufacture, Supply, Testing, Commissioning and Training of 45 Nos. Standard Gauge Cars including Signalling and Train Control System for Lucknow Metro Phase 1B Project				
Pre Qualification Details	Please refer Tender documents.				
Independent External Monitor/Remarks	NA				
Tender Value in ₹	NA	Product Category	Civil Works	Sub category	Design, Manufacture, Supply, Testing, Commissionin
Contract Type	Tender	Bid Validity(Days)	180	Period Of Work(Days)	1351
Location	LUCKNOW	Pincode	226010	Pre Bid Meeting Place	Online
Pre Bid Meeting Address	Online	Pre Bid Meeting Date	10-Jun-2026 03:00 PM	Bid Opening Place	UPMRC HEAD OFFICE LUCKNOW
Should Allow NDA Tender	No	Allow Preferential Bidder	No		

Critical Dates



Publish Date	01-May-2026 12:00 PM	Bid Opening Date	08-Jul-2026 03:00 PM
Document Download / Sale Start Date	01-May-2026 12:00 PM	Document Download / Sale End Date	07-Jul-2026 03:00 PM
Clarification Start Date	01-May-2026 12:00 PM	Clarification End Date	17-Jun-2026 06:00 PM
Bid Submission Start Date	24-Jun-2026 11:00 AM	Bid Submission End Date	07-Jul-2026 03:00 PM

Tender Documents

NIT Document	S.No	Document Name	Description	Document Size (in KB)
	1	Tendernotice_1.pdf	NIT	148.83

Work Item Documents	S.No	Document Type	Document Name	Description	Document Size (in KB)
	1	Tender Documents	Volume1.pdf	Volume 1	5407.65
	2	Tender Documents	Volume2.pdf	Volume 2	3473.05
	3	Other Document	Volume4.pdf	Volume 4	2174.00
	4	Other Document	Volume3.pdf	Volume 3	13864.10
	5	BOQ	BOQ_322664.xls	BOQ	626.50

Latest Corrigendum List

S.No	Corrigendum Title	Corrigendum Type	View
1	Addendum 01 for Date Extension	Date	
2	Addendum 01 for Technical	Technical Bid	

Tender Inviting Authority

Name	Director Rolling Stock and Systems
Address	Uttar Pradesh Metro Rail Corporation Ltd., Administrative Building, Near Samajik Parivartan Sthal, Vipin Khand, Gomti Nagar, Lucknow 226 010, Uttar Pradesh, India

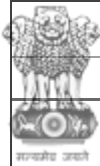

Organisation Chain :	Uttar Pradesh Metro Rail Corporation Limited Contract Cell - UPMRCL
Tender ID :	2026_UPMRC_276284_1
Tender Ref No :	LKRS-02
Tender Title :	Design, Manufacture, Supply, Testing, Commissioning and Training of 45 Nos. Standard Gauge Cars including Signalling and Train Control System for Lucknow Metro Phase 1B Project
Corrigendum Type :	Date

Corrigendum:1

Corrigendum Title	Corrigendum Description	Published Date	Document Name	Doc Size(in KB)
Addendum 01 for Date Extension	Addendum 01 for Date Extension	19-May-2026 05:26 PM	Addendum_01_Date_Technical.pdf 	7355.82

Critical Dates

Publish Date	01-May-2026 12:00 PM	Bid Opening Date	08-Jul-2026 03:00 PM
Document Download/Sale Start Date	01-May-2026 12:00 PM	Document Download/Sale End Date	07-Jul-2026 03:00 PM
Clarification Start Date	01-May-2026 12:00 PM	Clarification End Date	17-Jun-2026 06:00 PM
Bid Submission Start Date	24-Jun-2026 11:00 AM	Bid Submission End Date	07-Jul-2026 03:00 PM
Pre Bid Meeting Date	10-Jun-2026 03:00 PM		

Details Before Corrigendum

Critical Dates

Publish Date	01-May-2026 12:00 PM	Bid Opening Date	17-Jun-2026 03:00 PM
Document Download/Sale Start Date	01-May-2026 12:00 PM	Document Download/Sale End Date	16-Jun-2026 03:00 PM
Clarification Start Date	01-May-2026 12:00 PM	Clarification End Date	27-May-2026 06:00 PM
Bid Submission Start Date	03-Jun-2026 11:00 AM	Bid Submission End Date	16-Jun-2026 03:00 PM
Pre Bid Meeting Date	20-May-2026 11:00 AM		

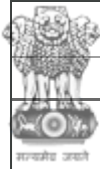

Organisation Chain :	Uttar Pradesh Metro Rail Corporation Limited Contract Cell - UPMRCL
Tender ID :	2026_UPMRC_276284_1
Tender Ref No :	LKRS-02
Tender Title :	Design, Manufacture, Supply, Testing, Commissioning and Training of 45 Nos. Standard Gauge Cars including Signalling and Train Control System for Lucknow Metro Phase 1B Project
Corrigendum Type :	Technical Bid

Corrigendum Document Details

Corr.No.	Corrigendum Title	Corrigendum Description	Published Date	Document Name	Doc Size(in KB)
1	Addendum 01 for Technical	Addendum 01 for Technical	19-May-2026 05:18 PM	Addendum_01_Date_Technical.pdf 	7355.82



उत्तर प्रदेश मेट्रो रेल कॉरपोरेशन लि०

UTTAR PRADESH METRO RAIL CORPORATION LTD.

(भारत सरकार एवं उत्तर प्रदेश सरकार का संयुक्त उपक्रम)
(A JOINT VENTURE OF GOVT. OF INDIA & GOVT. OF U.P.)

No. UPMRC/LKRS-02/Tender

Date: 19.05.2026

Addendum-1

Name of Work: Tender 'LKRS-02' - 'Design, Manufacture, Supply, Testing, Commissioning and Training of 45 Nos. Standard Gauge Cars Including Signalling & Train Control System for Lucknow Metro (Phase-1B) Project'.

Addendum-1 for Tender 'LKRS-02', as approved by the competent authority, is attached herewith.

For any further modifications/changes, if any, bidders are advised to stay updated on the e-tendering portal (<https://etenders.gov.in/eprocure/app>) for information.

(Shamim Ahmad)

General Manager/Rolling Stock

(ISO 9001:2015, ISO 14001:2015, ISO 45001:2018 द्वारा प्रमाणित कम्पनी)

(AN ISO 9001:2015, ISO 14001:2015, ISO 45001:2018 Certified Company)

प्रशासनिक भवन, निकट डॉ. भीमराव अंबेडकर सामाजिक परिवर्तन स्थल, विपिन खंड, गोमतीनगर, लखनऊ-226010
Administrative Building, Near Dr. Bhimrao Ambedkar Samajik Parivartan Sthal, Vipin Khand, Gomti Nagar, Lucknow-226010
Tel / दूरभाष : +91 522 2304014 | Fax / फ़ैक्स : +91 522 2304012 | Website / वेबसाइट : www.upmetrorail.com

Addendum-1 Attachment

Tender: LKRS-02

Tender ID: 2026_UPMRC_276284_1

The terms and conditions of the Tender Document stands modified to the extent indicated below and all other terms and conditions of the Tender Document remains unaltered:

Volume	Portion	Chapter/Section	Page	Clause	Existing para/sub-para/clause	Amendments			Modified para/sub-para/clause/New Clause
						Add	Deleted	Modified	
Volume 1	Notice of Invitation to Tender	-	Page 2 of 3	8	Pre-Tender Meeting: 20-05-2026 @ 15:00			✓	Pre-Tender Meeting: 10-06-2026 @ 15:00
Volume 1	Notice of Invitation to Tender	-	Page 3 of 3	10	Last Date and Time of Submission/ Uploading of Tender: 16-06-2026 @ 15:00			✓	Last Date and Time of Submission/ Uploading of Tender: 07-07-2026 @ 15:00
Volume 1	Notice of Invitation to Tender	-	Page 3 of 3	11	Date and Time of Opening of Tender (Technical Tender): 17-06-2026 @ 15:00			✓	Date and Time of Opening of Tender (Technical Tender): 08-07-2026 @ 15:00
Volume 1	Form of Tender	Appendix FT-1	Page 7 of 32	13	Place, date and time of Tender Submission and Tender opening: • Last Date and Time for Tender Submission: 16-06-2026 @ 15:00 • Date and Time for Tender Opening: 17-06-2026 @ 15:00			✓	Place, date and time of Tender Submission and Tender opening: • Last Date and Time for Tender Submission: 07-07-2026 @ 15:00 • Date and Time for Tender Opening: 08-07-2026 @ 15:00
Volume 1	Form of Tender	Appendix FT-1	Page 7 of 32	16	Place, date and time of Pre-bid Meeting • Date and Time: 20-05-2026 @ 11:00			✓	Place, date and time of Pre-bid Meeting • Date and Time: 10-06-2026 @ 15:00
Volume 1	Form of Tender	Appendix FT-1	Page 8 of 32	17	Last date up to which clarification on tender conditions can be sought: 27-05-2026 (The replies to the clarifications and required Addendum, if any, will be issued at least two (02) weeks in advance of due date for Tender Submission i.e., before closing of business hours on 02-06-2026.)			✓	Last date up to which clarification on tender conditions can be sought: 17-06-2026 (The replies to the clarifications and required Addendum, if any, will be issued at least two (02) weeks in advance of due date for Tender Submission i.e., before closing of business hours on 23-06-2026.)
Volume 4	Tender Drawings	-	Page 3 of 127	-	-	✓			Tender Drawings are attached as Appendix-I.
Volume 3	Employer's Requirements: General Specifications Rolling Stock	Appendix 2, MONTHLY PROGRESS REPORT	-	-	-			✓	4.(iv) The Contractor shall submit, for the relevant month, a tabulated report detailing the progress of indigenisation activities, together with supporting documents demonstrating that all reasonable efforts are being made to maximise indigenisation without compromising the prescribed performance requirements, quality standards, or technical specifications.

Addendum-1 Attachment

Tender: LKRS-02

Tender ID: 2026_UPMRC_276284_1

The terms and conditions of the Tender Document stands modified to the extent indicated below and all other terms and conditions of the Tender Document remains unaltered:

Volume	Portion	Chapter/Section	Page	Clause	Existing para/sub-para/clause	Amendments			
						Add	Deleted	Modified	
Volume 3	Employer's Requirements: General Specifications Rolling Stock	Appendix 6	21	6.4.1	Tenderers shall submit list of overhauling spares for two train sets each for three cars and six cars and quote for the same as per 'Annexure-G6' in 'Instructions to Tenderers, Annexure ITT-2B, Pricing document'. Prices of spares shall be actual prices and not apportioned prices. The spares shall be delivered at the nominated depots by the Employer. The delivery is linked to the key dates indicated in the notes under Cost Centre 'G' of 'Instructions to Tenderers, Annexure ITT-2B, Pricing document'.			✓	Tenderers shall submit list of overhauling spares for two train sets each for three cars and six cars as indicated in and quote for the same as per 'Annexure-G6' in 'Instructions to Tenderers, Annexure ITT-2B, Pricing document'. Prices of spares shall be actual prices and not apportioned prices. The spares shall be delivered at the nominated depots by the Employer. The delivery is linked to the key dates indicated in the notes under Cost Centre 'G' of 'Instructions to Tenderers, Annexure ITT-2B, Pricing document'.
Volume 3	Employer's Requirements: General Specifications Rolling Stock	Appendix 9	46	6.1.2.(iv)	Working days for twelve (12) instructors for CBT module			✓	Fifteen (15) working days for twelve (12) instructors for CBT module
Volume 3	Employer's Requirements: Technical Specifications Rolling Stock	2. GENERAL REQUIREMENTS	-	-	-	✓			2.15.8 The Contractor shall ensure compatibility and correct functioning of the system with the power supply conditions of the Lucknow Metro (Phase-1B) network, including operation with other train-sets, power supply fluctuations / interruptions, and feed extensions, and shall carry out all necessary measurements and assessments.
Volume 3	Employer's Requirements: Technical Specifications Rolling Stock	2. GENERAL REQUIREMENTS	-	-	-	✓			2.15.9 The Contractor shall furnish harmonic emission / spectrum details of the fleet / train-set / unit at collector shoe level in both traction and regenerative modes, based on simulation studies, and validate compliance through tests in accordance with relevant EN / IEC or equivalent standards. The Contractor shall also furnish power quality details of regenerated energy, including harmonic analysis, in compliance with the Indian Electricity Grid Code.
Volume 3	Employer's Requirements: Technical Specifications Rolling Stock	8. HIGH VOLTAGE AND PROPULSION	-	-	-	✓			8.1.11 In the event of failure or loss of traction power supply, the train-set in AW3 loading condition shall be capable of self-propulsion on battery power up to the nearest station at a jog speed not less than 5 kmph. The Contractor shall demonstrate and validate compliance with this requirement during design verification and system testing.

Addendum-1 Attachment

Tender: LKRS-02

Tender ID: 2026_UPMRC_276284_1

The terms and conditions of the Tender Document stands modified to the extent indicated below and all other terms and conditions of the Tender Document remains unaltered:

Volume	Portion	Chapter/Section	Page	Clause	Existing para/sub-para/clause	Amendments			
						Add	Deleted	Modified	
Volume 3	Employer's Requirements: Technical Specifications Rolling Stock	9. AUXILIARY SUPPLY	-	-	-	✓			9.4.2.(iv) Enabling self-propulsion of an AW3-loaded train-set on battery power up to the nearest station at a jog speed not less than 5 kmph in the event of failure or loss of traction power supply. Compliance with this requirement shall be demonstrated during design verification and system testing.
Volume 3	Employer's Requirements: Technical Specifications Rolling Stock	10. TRAIN CONTROL AND MONITORING SYSTEM	-	-	-	✓			<p>10.14.1.(iv) The cyber security solution shall, at a minimum, provide protection, detection, prevention, and mitigation measures against the following cyber threats and attack vectors:</p> <ul style="list-style-type: none"> (i) Denial of Service (DoS) attacks; (ii) Distributed Denial of Service (DDoS) attacks; (iii) Hacking and unauthorised access; (iv) Malware; (v) Viruses; (vi) Trojan Horses; (vii) Ransomware; (viii) Botnets; (ix) Adware (pop up including advertisements); (x) Phishing attacks; (xi) IP spoofing; (xii) Spamming; (xiii) Man-in-the-middle attacks; and (xiv) Packet sniffing and unauthorised interception of network traffic. <p>The Contractor shall demonstrate compliance with the above requirements through third-party cyber security risk assessment, security validation, and Vulnerability Assessment and Penetration Testing (VAPT) prior to commissioning.</p>
Volume 3	Employer's Requirements: Technical Specifications Rolling Stock	10. TRAIN CONTROL AND MONITORING SYSTEM	Page 180 of 362	10.14.8.(i)	The Contractor shall perform and document the following: (a) Vulnerability Assessment and Penetration Testing (VAPT) of onboard networks and interfaces. (b) Security validation of firmware / software update processes. (c) Compliance verification against applicable standards (IEC 62443, EN 50159, etc.).			✓	<p>The Contractor shall perform third-party testing and certification, and document the following:</p> <ul style="list-style-type: none"> (a) Vulnerability Assessment and Penetration Testing (VAPT) of onboard networks and interfaces. (b) Security validation of firmware / software update processes. (c) Compliance verification against applicable standards (IEC 62443, EN 50159, etc.).

Appendix-I

**GAUTAM BUDHA MARG STATION
AT CH: 0+989.633m**



GAUTAM BUDHA STATION

Ch. 0+989.633 m
Level 100.500 m

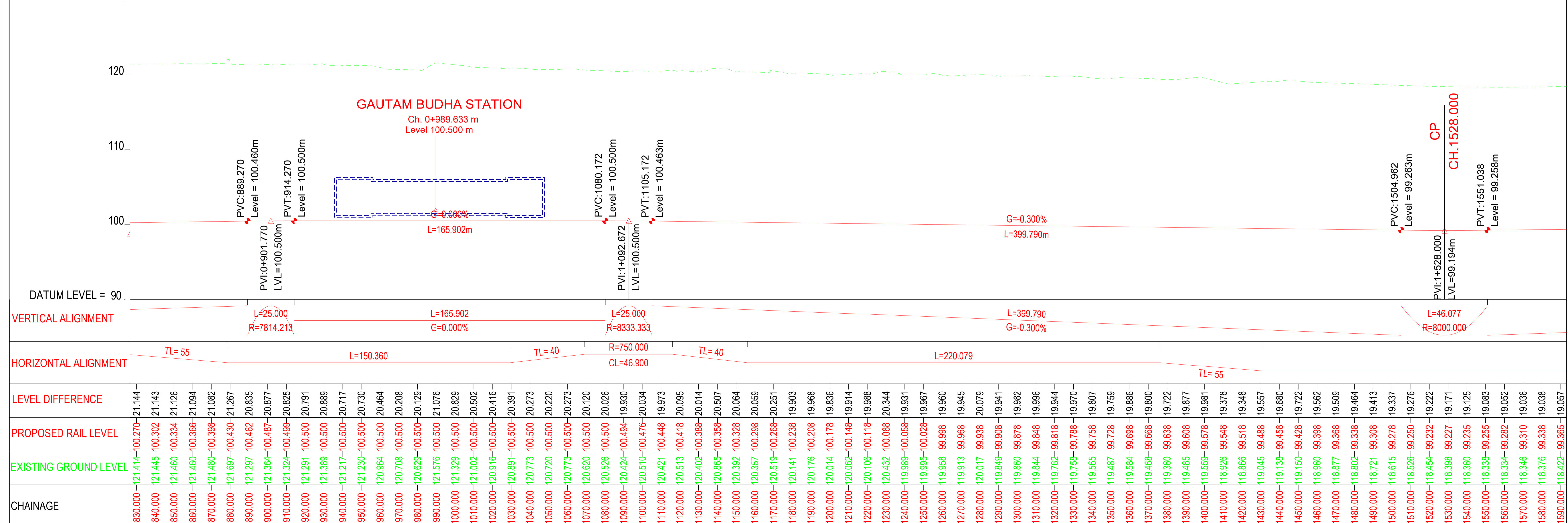

GENERAL NOTES:

1. ALL DIMENSIONS ARE IN MILLIMETER UNLESS MENTIONED.
2. ALL DIMENSIONS ARE TO BE READ AND NOT MEASURED.
3. ANY DISCREPANCY MUST BE BROUGHT TO THE NOTICE OF THE DMRC BEFORE EXECUTION OF WORK AT SITE.
4. THIS DRAWING MUST BE READ IN CONJUNCTION WITH ALL RELEVANT ARCHITECTURAL, STRUCTURAL, PLUMBING & FIRE FIGHTING, ELECTRICAL AND TRAFFIC MANAGEMENT DRAWINGS.

REVISION	REFERENCE DRAWINGS	DESCRIPTION	DRAWING NO.

REV.	DESCRIPTION	DATE	DRAWN BY	CHECKED BY

APPROVAL OF LMRC OFFICIALS

--	--	--	--

Confirmed that this document has been designed and checked in accordance with DDC Quality Assurance Plan.

Authorised Signatory for DDC, LUCKNOW/DCD Project Manager

Architecture Design In-charge/ Coordinator	Structure Design In-charge/ Coordinator	E&M Design In-charge/ Coordinator
---	--	--------------------------------------

DETAIL DESIGN CONSULTANT :

ayesa

Ayesa India Private Limited
D 99, 3rd Floor, Sector 2, Noida -201301, Gautam Budh Nagar, Uttar Pradesh
Tel.: +(91) 120 490 8800, Email: delhi@ayesa.com

PROJECT TITLE:
UTTAR PRADESH METRO RAIL CORPORATION LTD.
(Formerly known as Lucknow Metro Rail Corporation Ltd.)

DRAWING TITLE:
GENERAL ALIGNMENT DRAWING - UP MAIN
CH: 830.00 to 1590.00

NORTH	DRAWN BY:	CHECKED BY:	VERIFIED BY:	APPROVED BY:

ORDER N° DRAWING NUMBER: SHEET NO. 2 of 9 SHEET SIZE A1

DDC

This drawing must not be either loaned, copied or otherwise reproduced in whole or in part or used for any purpose without the prior written permission of LMRC.

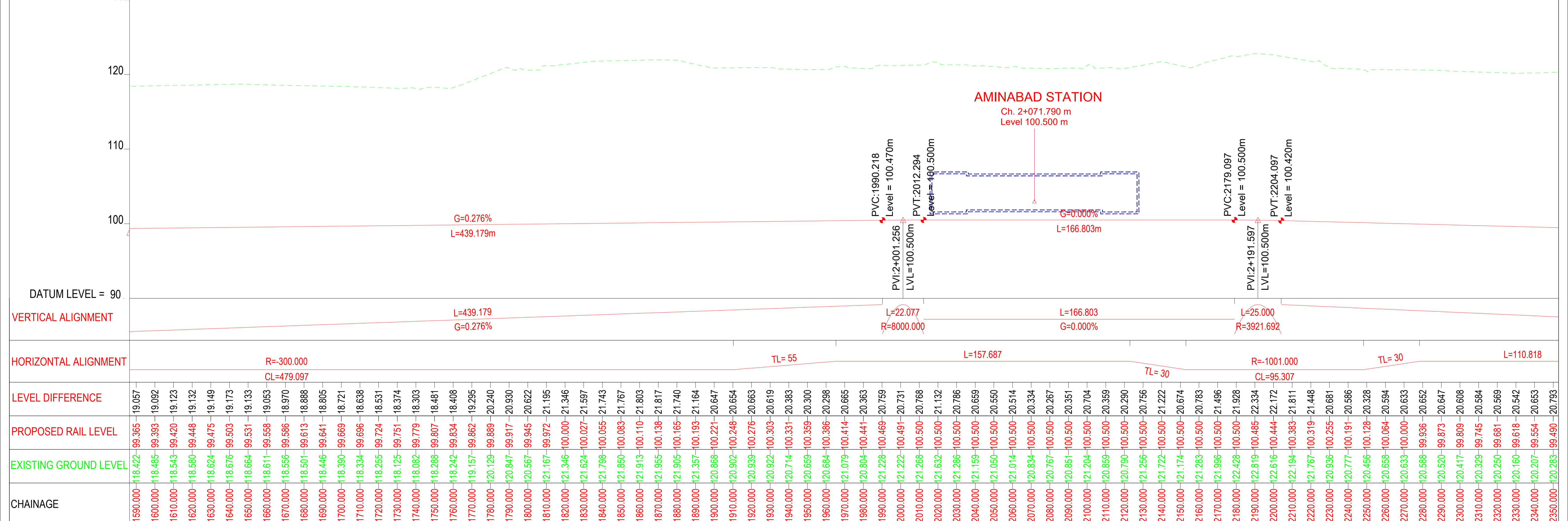
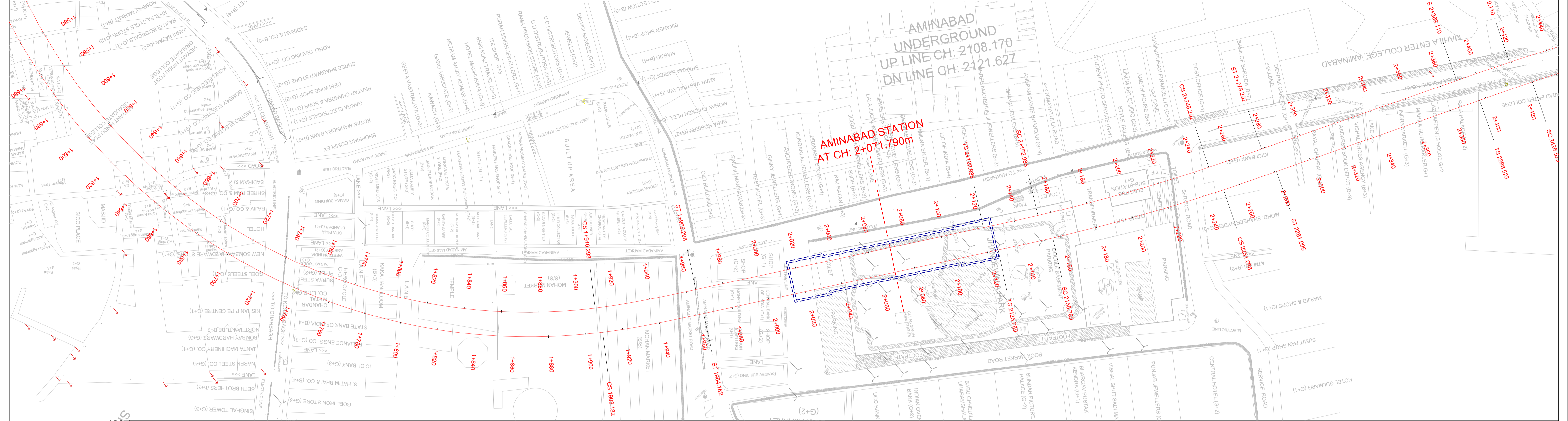

GENERAL NOTES:
 1. ALL DIMENSIONS ARE IN MILLIMETER UNLESS MENTIONED.
 2. ALL DIMENSIONS ARE TO BE READ AND NOT MEASURED.
 3. ANY DISCREPANCY MUST BE BROUGHT TO THE NOTICE OF THE DMRC BEFORE EXECUTION OF WORK AT SITE.
 4. THIS DRAWING MUST BE READ IN CONJUNCTION WITH ALL RELEVANT ARCHITECTURAL, STRUCTURAL, PLUMBING & FIRE FIGHTING, ELECTRICAL AND TRAFFIC MANAGEMENT DRAWINGS.

REVISION	REFERENCE DRAWINGS	DESCRIPTION	DRAWING NO.

REV.	DESCRIPTION	DATE	DRAWN BY	CHECKED BY

APPROVAL OF LMRC OFFICIALS	

Certified that this document has been designed and checked in accordance with DDC Quality Assurance Plan.

Architecture Design In-charge/ Coordinator
 Structure Design In-charge/ Coordinator
 E&M Design In-charge/ Coordinator

Authorised Signatory for DDC, LUCKNOWDDC Project Manager

DETAIL DESIGN CONSULTANT : **ayesa**

Ayesa India Private Limited
 D 99, 3rd Floor, Sector 2, Noida -201301, Gautam Budh Nagar, Uttar Pradesh
 Tel.: +(91) 120 490 8800, Email: delhi@ayesa.com

PROJECT TITLE: **UTTAR PRADESH METRO RAIL CORPORATION LTD.**
 (Formerly known as Lucknow Metro Rail Corporation Ltd.)

DRAWING TITLE: **GENERAL ALIGNMENT DRAWING - UP MAIN**
 CH: 1590.00 to 2350.00

NORTH	DRAWN BY:	CHECKED BY:	VERIFIED BY:	APPROVED BY:

ORDER N° DRAWING NUMBER: SHEET NO. 3 of 9 SHEET SIZE A1

DDC

This drawing must not be either loaned, copied or otherwise reproduced in whole or in part or used for any purpose without the prior written permission of LMRC.

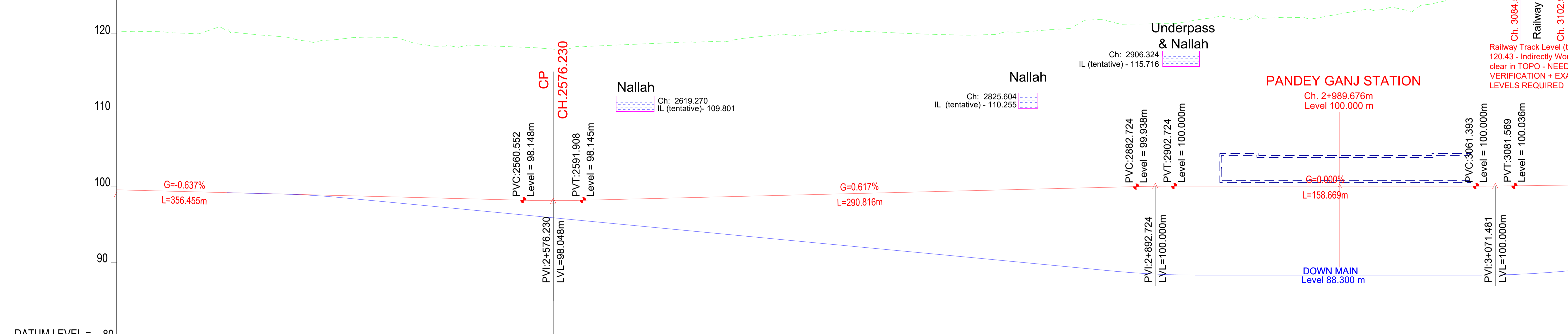

CHAINAGE	EXISTING GROUND LEVEL	PROPOSED RAIL LEVEL	LEVEL DIFFERENCE	HORIZONTAL ALIGNMENT	VERTICAL ALIGNMENT
2350.000	20.283	20.793	0.510	TL=30	L=356.455 G=-0.637%
2360.000	20.316	20.890	0.574		
2370.000	20.274	20.911	0.637		
2380.000	20.103	20.804	0.701		
2390.000	20.012	20.777	0.765		
2400.000	20.067	20.696	0.629		
2410.000	20.151	20.108	0.954		
2420.000	19.902	20.858	0.956		
2430.000	19.694	20.714	1.020		
2440.000	19.324	20.408	1.084		
2450.000	18.882	20.029	1.147		
2460.000	19.120	20.420	1.300		
2470.000	19.485	20.760	1.275		
2480.000	19.476	20.815	1.339		
2490.000	19.500	20.902	1.402		
2500.000	19.022	20.488	1.466		
2510.000	18.520	20.050	1.530		
2520.000	18.415	20.406	1.591		
2530.000	18.458	20.343	1.685		
2540.000	18.446	20.279	1.733		
2550.000	18.341	20.132	1.791		
2560.000	18.247	20.095	1.848		
2570.000	18.117	20.011	1.894		
2580.000	17.858	19.758	1.897		
2590.000	18.295	20.161	1.866		
2600.000	18.423	20.228	1.805		
2610.000	18.532	20.276	1.744		
2620.000	18.641	20.323	1.682		
2630.000	18.750	20.370	1.620		
2640.000	18.859	20.418	1.559		
2650.000	18.911	20.408	1.497		
2660.000	18.994	20.429	1.435		
2670.000	19.157	20.531	1.374		
2680.000	19.501	20.821	1.320		
2690.000	19.764	21.014	1.250		
2700.000	19.872	21.061	1.189		
2710.000	19.954	21.081	1.127		
2720.000	20.217	21.282	1.065		
2730.000	20.519	21.523	1.004		
2740.000	20.312	21.254	0.942		
2750.000	20.203	21.083	0.880		
2760.000	20.084	20.903	0.819		
2770.000	19.985	20.742	0.757		
2780.000	19.906	20.601	0.695		
2790.000	19.846	20.480	0.634		
2800.000	19.856	20.428	0.572		
2810.000	20.010	20.520	0.510		
2820.000	20.212	20.661	0.449		
2830.000	20.390	20.777	0.387		
2840.000	20.597	20.922	0.325		
2850.000	20.992	21.255	0.263		
2860.000	21.848	22.050	0.202		
2870.000	21.548	21.688	0.140		
2880.000	21.281	21.359	0.078		
2890.000	21.318	21.343	0.025		
2900.000	21.333	21.334	0.001		
2910.000	21.637	21.637	0.000		
2920.000	22.020	22.026	0.006		
2930.000	22.218	22.218	0.000		
2940.000	21.850	21.850	0.000		
2950.000	22.051	22.051	0.000		
2960.000	22.167	22.167	0.000		
2970.000	22.132	22.132	0.000		
2980.000	22.183	22.183	0.000		
2990.000	22.629	22.629	0.000		
3000.000	23.062	23.062	0.000		
3010.000	23.132	23.132	0.000		
3020.000	23.355	23.355	0.000		
3030.000	23.326	23.326	0.000		
3040.000	24.052	24.052	0.000		
3050.000	24.655	24.655	0.000		
3060.000	24.555	24.555	0.000		
3070.000	25.004	25.007	0.003		
3080.000	25.265	25.234	-0.031		
3090.000	25.726	25.659	-0.067		
3100.000	25.725	25.622	-0.103		
3110.000	25.454	25.320	-0.134		

GENERAL NOTES:
 1. ALL DIMENSIONS ARE IN MILLIMETER UNLESS MENTIONED.
 2. ALL DIMENSIONS ARE TO BE READ AND NOT MEASURED.
 3. ANY DISCREPANCY MUST BE BROUGHT TO THE NOTICE OF THE DMRC BEFORE EXECUTION OF WORK AT SITE.
 4. THIS DRAWING MUST BE READ IN CONJUNCTION WITH ALL RELEVANT ARCHITECTURAL, STRUCTURAL, PLUMBING & FIRE FIGHTING, ELECTRICAL AND TRAFFIC MANAGEMENT DRAWINGS.

REVISION	REFERENCE DRAWINGS	DESCRIPTION	DRAWING NO.

REV.	DESCRIPTION	DATE	DRAWN BY	CHECKED BY

APPROVAL OF LMRC OFFICIALS				

Confirmed that this document has been designed and checked in accordance with DDC Quality Assurance Plan.

Authorised Signatory for DDC, LUCKNOWDDC Project Manager

Architecture Design In-charge/ Coordinator
 Structure Design In-charge/ Coordinator
 E&M Design In-charge/ Coordinator

DETAIL DESIGN CONSULTANT :

ayesa

Ayesa India Private Limited
 D 99, 3rd Floor, Sector 2, Noida -201301, Gautam Budh Nagar, Uttar Pradesh
 Tel.: +(91) 120 490 8800, Email: delhi@ayesa.com

PROJECT TITLE: **UTTAR PRADESH METRO RAIL CORPORATION LTD.**
 (Formerly known as Lucknow Metro Rail Corporation Ltd.)

DRAWING TITLE: **GENERAL ALIGNMENT DRAWING - UP MAIN**
 CH: 2350.00 to 3110.00

NORTH	DRAWN BY:	CHECKED BY:	VERIFIED BY:	APPROVED BY:

ORDER N°: DRAWING NUMBER: SHEET NO. 4 of 9 SHEET SIZE A1

DDC

This drawing must not be either loaned, copied or otherwise reproduced in whole or in part or used for any purpose without the prior written permission of LMRC.

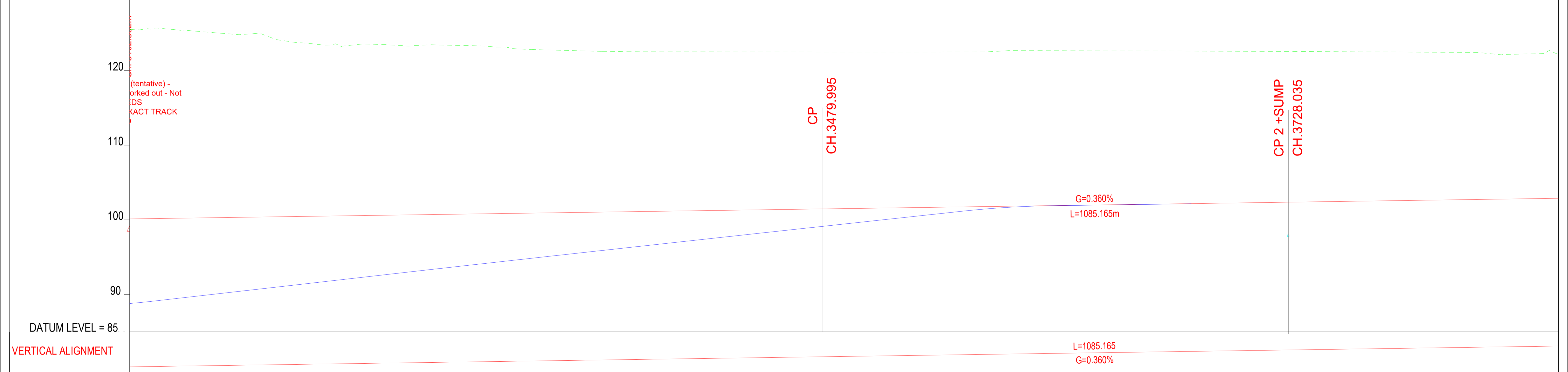

LEVEL DIFFERENCE	PROPOSED RAIL LEVEL	EXISTING GROUND LEVEL	CHAINAGE
25.320	100.139	125.459	3110.000
25.501	100.175	125.676	3120.000
25.277	100.211	125.488	3130.000
25.067	100.247	125.314	3140.000
24.824	100.283	125.107	3150.000
24.586	100.319	124.905	3160.000
24.530	100.355	124.885	3170.000
24.254	100.391	124.645	3180.000
23.539	100.427	123.966	3190.000
23.231	100.463	123.694	3200.000
22.920	100.499	123.419	3210.000
22.656	100.535	123.191	3220.000
22.946	100.571	123.517	3230.000
22.891	100.607	123.498	3240.000
22.729	100.643	123.372	3250.000
22.662	100.679	123.341	3260.000
22.723	100.715	123.438	3270.000
22.626	100.751	123.377	3280.000
22.536	100.787	123.323	3290.000
22.388	100.823	123.211	3300.000
22.199	100.859	123.058	3310.000
21.942	100.895	122.837	3320.000
21.721	100.931	122.830	3330.000
21.490	100.967	122.830	3340.000
21.440	101.003	122.830	3350.000
21.529	101.039	122.830	3360.000
21.462	101.075	122.830	3370.000
21.405	101.112	122.830	3380.000
21.364	101.148	122.830	3390.000
21.325	101.184	122.830	3400.000
21.287	101.220	122.830	3410.000
21.251	101.256	122.830	3420.000
21.201	101.292	122.830	3430.000
21.159	101.328	122.830	3440.000
21.119	101.364	122.830	3450.000
21.079	101.400	122.830	3460.000
21.040	101.436	122.830	3470.000
21.002	101.472	122.830	3480.000
20.964	101.508	122.830	3490.000
20.927	101.544	122.830	3500.000
20.891	101.580	122.830	3510.000
20.856	101.616	122.830	3520.000
20.821	101.652	122.830	3530.000
20.787	101.688	122.830	3540.000
20.754	101.724	122.830	3550.000
20.721	101.760	122.830	3560.000
20.756	101.796	122.830	3570.000
20.830	101.832	122.830	3580.000
20.791	101.868	122.830	3590.000
20.750	101.904	122.830	3600.000
20.709	101.940	122.830	3610.000
20.666	101.976	122.830	3620.000
20.626	102.012	122.830	3630.000
20.584	102.048	122.830	3640.000
20.541	102.084	122.830	3650.000
20.497	102.120	122.830	3660.000
20.455	102.156	122.830	3670.000
20.408	102.192	122.830	3680.000
20.363	102.228	122.830	3690.000
20.318	102.264	122.830	3700.000
20.272	102.300	122.830	3710.000
20.225	102.336	122.830	3720.000
20.178	102.372	122.830	3730.000
20.130	102.409	122.830	3740.000
20.082	102.445	122.830	3750.000
20.034	102.481	122.830	3760.000
19.985	102.517	122.830	3770.000
19.936	102.553	122.830	3780.000
19.886	102.589	122.830	3790.000
19.837	102.625	122.830	3800.000
19.787	102.661	122.830	3810.000
19.737	102.697	122.830	3820.000
19.679	102.733	122.830	3830.000
19.398	102.769	122.830	3840.000
19.379	102.805	122.830	3850.000
19.403	102.841	122.830	3860.000
19.590	102.877	122.830	3870.000

GENERAL NOTES:
 1. ALL DIMENSIONS ARE IN MILLIMETER UNLESS MENTIONED.
 2. ALL DIMENSIONS ARE TO BE READ AND NOT MEASURED.
 3. ANY DISCREPANCY MUST BE BROUGHT TO THE NOTICE OF THE DMRC BEFORE EXECUTION OF WORK AT SITE.
 4. THIS DRAWING MUST BE READ IN CONJUNCTION WITH ALL RELEVANT ARCHITECTURAL, STRUCTURAL, PLUMBING & FIRE FIGHTING, ELECTRICAL AND TRAFFIC MANAGEMENT DRAWINGS.

REVISION	REFERENCE DRAWINGS	DESCRIPTION	DRAWING NO.

REV.	DESCRIPTION	DATE	DRAWN BY	CHECKED BY

APPROVAL OF LMRC OFFICIALS				

Certified that this document has been designed and checked in accordance with DDC Quality Assurance Plan.

Architecture Design In-charge/ Coordinator: _____
 Structure Design In-charge/ Coordinator: _____
 E&M Design In-charge/ Coordinator: _____

DETAIL DESIGN CONSULTANT : **ayesa**

Ayesa India Private Limited
 D 99, 3rd Floor, Sector 2, Noida -201301, Gautam Budh Nagar, Uttar Pradesh
 Tel.: +(91) 120 490 8800, Email: delhi@ayesa.com

PROJECT TITLE: **UTTAR PRADESH METRO RAIL CORPORATION LTD.**
 (Formerly know as Lucknow Metro Rail Corporation Ltd.)

DRAWING TITLE: **GENERAL ALIGNMENT DRAWING - UP MAIN**
 CH: 3110.00 to 3870.00

NORTH	DRAWN BY:	CHECKED BY:	VERIFIED BY:	APPROVED BY:

ORDER N°: _____ DRAWING NUMBER: _____ SHEET NO. 5 of 9 SHEET SIZE A1

DDC

THIS DRAWING IS THE PROPERTY OF LUCKNOW METRO RAIL CORPORATION LTD.

This drawing must not be either loaned, copied or otherwise reproduced in whole or in part or used for any purpose without the prior written permission of LMRC.

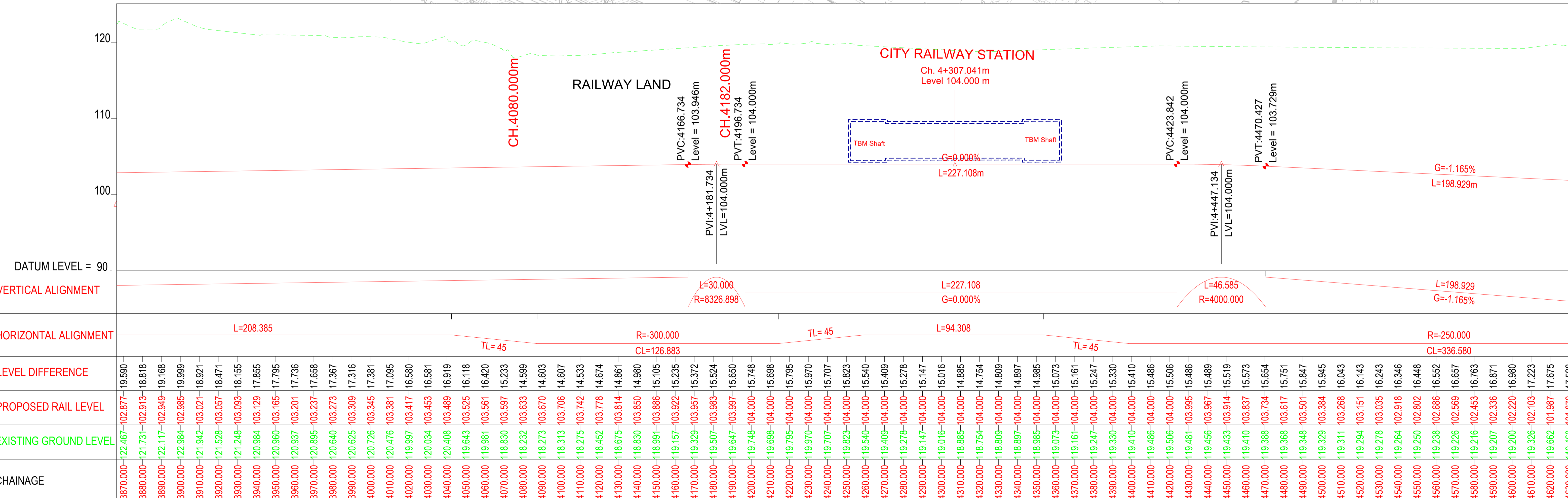
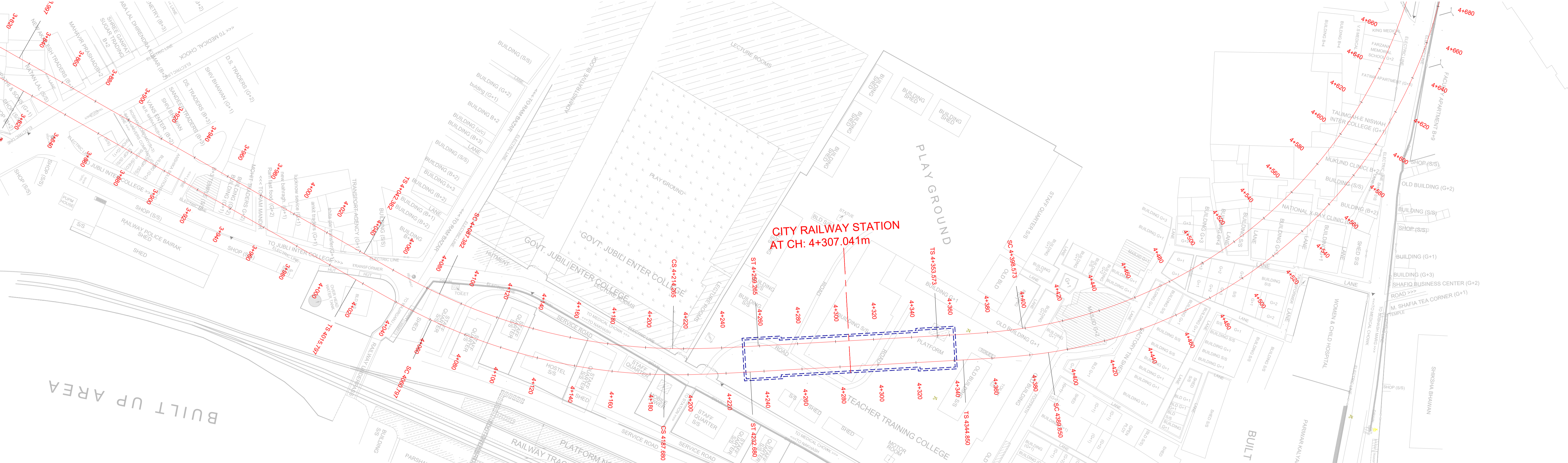

GENERAL NOTES:

1. ALL DIMENSIONS ARE IN MILLIMETER UNLESS MENTIONED.
2. ALL DIMENSIONS ARE TO BE READ AND NOT MEASURED.
3. ANY DISCREPANCY MUST BE BROUGHT TO THE NOTICE OF THE DMRC BEFORE EXECUTION OF WORK AT SITE.
4. THIS DRAWING MUST BE READ IN CONJUNCTION WITH ALL RELEVANT ARCHITECTURAL, STRUCTURAL, PLUMBING & FIRE FIGHTING, ELECTRICAL AND TRAFFIC MANAGEMENT DRAWINGS.

REVISION	REFERENCE DRAWINGS	DESCRIPTION	DRAWING NO.

REV.	DESCRIPTION	DATE	DRAWN BY	CHECKED BY

APPROVAL OF LMRC OFFICIALS

Certified that this document has been designed and checked in accordance with DDC Quality Assurance Plan.

Authorised Signatory for DDC, LUCKNOWDDC Project Manager

Architecture Design In-charge/ Coordinator Structure Design In-charge/ Coordinator E&M Design In-charge/ Coordinator

DETAIL DESIGN CONSULTANT :

ayesa

Ayesa India Private Limited
D 99, 3rd Floor, Sector 2, Noida -201301, Gautam Budh Nagar, Uttar Pradesh
Tel.: +(91) 120 490 8800, Email: delhi@ayesa.com

PROJECT TITLE: **UTTAR PRADESH METRO RAIL CORPORATION LTD.**
(Formerly known as Lucknow Metro Rail Corporation Ltd.)

DRAWING TITLE: **GENERAL ALIGNMENT DRAWING - UP MAIN**
CH: 3810.00 TO 4570.00

NORTH	DRAWN BY:	CHECKED BY:	VERIFIED BY:	APPROVED BY:
DATE:	REV:	SCALE:	STATUS:	DDC
ORDER N°	DRAWING NUMBER:	SHEET NO. 6 of 9	SHEET SIZE A1	

This drawing must not be either loaned, copied or otherwise reproduced in whole or in part or used for any purpose without the prior written permission of LMRC.

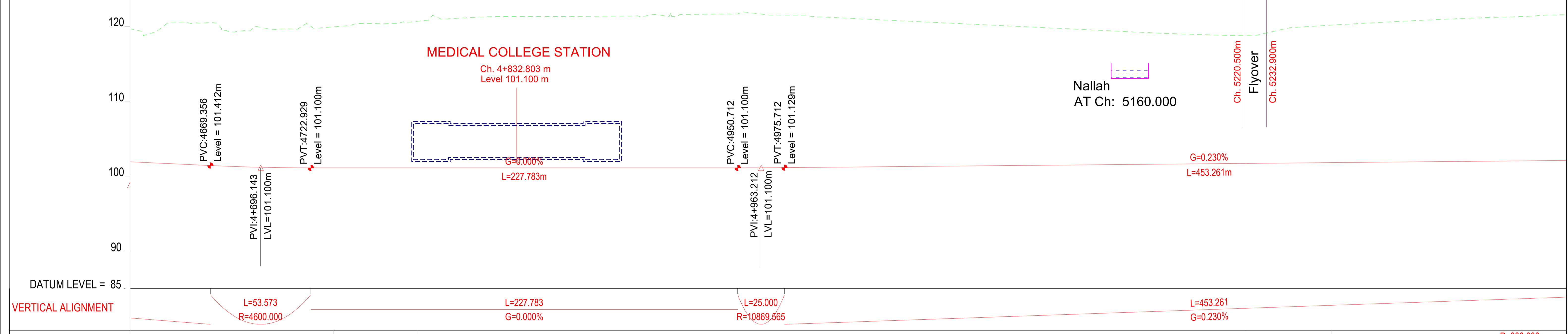

CHAINAGE	EXISTING GROUND LEVEL	PROPOSED RAIL LEVEL	LEVEL DIFFERENCE	HORIZONTAL ALIGNMENT	VERTICAL ALIGNMENT
4630.000	+19.468	+01.870	-17.598		
4640.000	+19.245	+01.754	-17.491		
4650.000	+20.544	+01.637	-18.907		
4660.000	+20.349	+01.521	-18.828		
4670.000	+20.483	+01.405	-19.076		
4680.000	+19.252	+01.300	-17.952		
4690.000	+19.465	+01.218	-18.247		
4700.000	+19.661	+01.157	-18.504		
4710.000	+19.634	+01.118	-18.516		
4720.000	+20.276	+01.101	-19.175		
4730.000	+19.818	+01.100	-18.718		
4740.000	+20.017	+01.100	-18.917		
4750.000	+20.356	+01.100	-19.256		
4760.000	+20.331	+01.100	-19.231		
4770.000	+20.447	+01.100	-19.347		
4780.000	+20.863	+01.100	-19.563		
4790.000	+21.228	+01.100	-20.128		
4800.000	+21.041	+01.100	-19.941		
4810.000	+21.181	+01.100	-20.081		
4820.000	+21.269	+01.100	-20.169		
4830.000	+21.281	+01.100	-20.181		
4840.000	+21.281	+01.100	-20.181		
4850.000	+21.280	+01.100	-20.180		
4860.000	+21.288	+01.100	-20.188		
4870.000	+21.310	+01.100	-20.210		
4880.000	+21.333	+01.100	-20.233		
4890.000	+21.356	+01.100	-20.256		
4900.000	+21.289	+01.100	-20.189		
4910.000	+21.457	+01.100	-20.357		
4920.000	+21.558	+01.100	-20.458		
4930.000	+21.583	+01.100	-20.483		
4940.000	+21.612	+01.100	-20.512		
4950.000	+21.642	+01.100	-20.542		
4960.000	+21.717	+01.104	-20.613		
4970.000	+21.485	+01.117	-20.368		
4980.000	+21.478	+01.139	-20.339		
4990.000	+21.297	+01.162	-20.135		
5000.000	+21.177	+01.185	-19.992		
5010.000	+21.058	+01.208	-19.850		
5020.000	+20.938	+01.231	-19.707		
5030.000	+20.818	+01.254	-19.564		
5040.000	+20.698	+01.277	-19.421		
5050.000	+20.578	+01.300	-19.276		
5060.000	+20.458	+01.323	-19.135		
5070.000	+20.338	+01.346	-18.992		
5080.000	+20.219	+01.369	-18.850		
5090.000	+20.099	+01.392	-18.707		
5100.000	+19.979	+01.415	-18.564		
5110.000	+19.859	+01.438	-18.421		
5120.000	+19.739	+01.461	-18.278		
5130.000	+19.619	+01.484	-18.135		
5140.000	+19.499	+01.507	-17.992		
5150.000	+19.380	+01.530	-17.850		
5160.000	+19.260	+01.553	-17.707		
5170.000	+19.140	+01.576	-17.564		
5180.000	+19.024	+01.599	-17.425		
5190.000	+18.944	+01.622	-17.322		
5200.000	+18.865	+01.645	-17.220		
5210.000	+18.785	+01.668	-17.117		
5220.000	+18.782	+01.691	-17.091		
5230.000	+18.929	+01.714	-17.215		
5240.000	+19.497	+01.737	-17.760		
5250.000	+19.872	+01.760	-18.112		
5260.000	+20.028	+01.783	-18.245		
5270.000	+20.179	+01.806	-18.373		
5280.000	+20.323	+01.829	-18.494		
5290.000	+20.460	+01.852	-18.608		
5300.000	+20.590	+01.875	-18.715		
5310.000	+20.718	+01.898	-18.820		
5320.000	+20.841	+01.921	-18.920		
5330.000	+20.957	+01.944	-19.013		
5340.000	+21.054	+01.967	-19.087		
5350.000	+21.142	+01.990	-19.152		
5360.000	+21.221	+02.013	-19.208		
5370.000	+21.291	+02.036	-19.255		
5380.000	+21.446	+02.059	-19.387		
5390.000	+21.528	+02.082	-19.446		

GENERAL NOTES:

- ALL DIMENSIONS ARE IN MILLIMETER UNLESS MENTIONED.
- ALL DIMENSIONS ARE TO BE READ AND NOT MEASURED.
- ANY DISCREPANCY MUST BE BROUGHT TO THE NOTICE OF THE DMRC BEFORE EXECUTION OF WORK AT SITE.
- THIS DRAWING MUST BE READ IN CONJUNCTION WITH ALL RELEVANT ARCHITECTURAL, STRUCTURAL, PLUMBING & FIRE FIGHTING, ELECTRICAL AND TRAFFIC MANAGEMENT DRAWINGS.

REVISION	REFERENCE DRAWINGS	DESCRIPTION	DRAWING NO.

REV.	DESCRIPTION	DATE	DRAWN BY	CHECKED BY

APPROVAL OF LMRC OFFICIALS				

Certified that this document has been designed and checked in accordance with DDC Quality Assurance Plan.

Authorised Signatory for DDC, LUCKNOWDDC Project Manager

Architecture Design In-charge/ Coordinator	Structure Design In-charge/ Coordinator	E&M Design In-charge/ Coordinator
--	---	-----------------------------------

DETAIL DESIGN CONSULTANT :

ayesa

Ayesa India Private Limited
D 99, 3rd Floor, Sector 2, Noida -201301, Gautam Budh Nagar, Uttar Pradesh
Tel.: +(91) 120 490 8800, Email: delhi@ayesa.com

PROJECT TITLE: **UTTAR PRADESH METRO RAIL CORPORATION LTD.**
(Formerly known as Lucknow Metro Rail Corporation Ltd.)

DRAWING TITLE: **GENERAL ALIGNMENT DRAWING - UP MAIN**
CH: 4630.00 to 5390.00

NORTH	DRAWN BY:	CHECKED BY:	VERIFIED BY:	APPROVED BY:

ORDER N° DRAWING NUMBER: SHEET NO. **7 of 9** SHEET SIZE **A1**

DDC

This drawing must not be either loaned, copied or otherwise reproduced in whole or in part or used for any purpose without the prior written permission of LMRC.

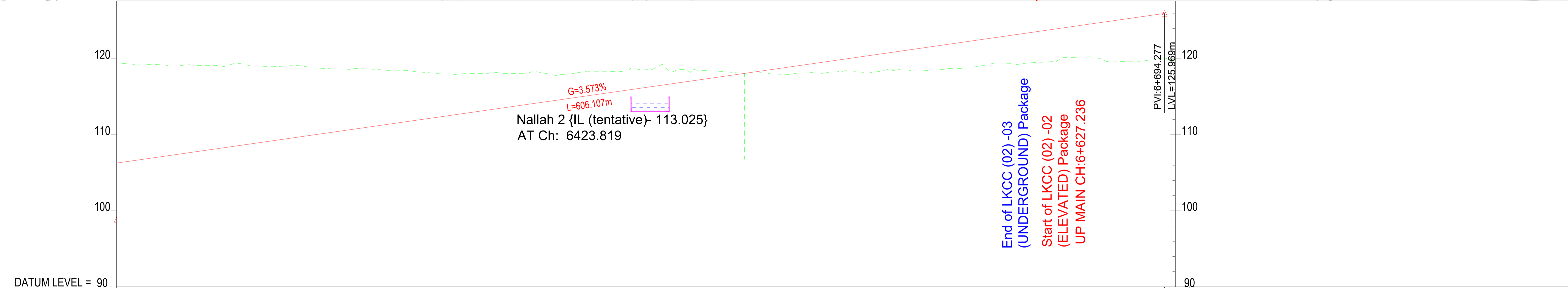
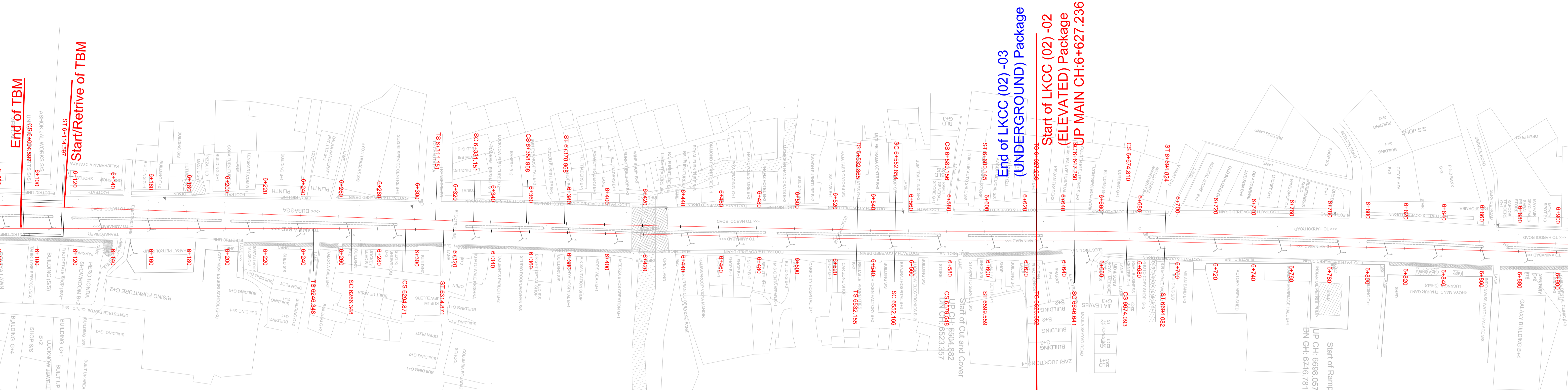

Vertical Alignment	Horizontal Alignment	Level Difference	Proposed Rail Level	Existing Ground Level	Chainage
L=196.554	L=153.896	12.802	106.520	119.322	6150.000
R=3500.000	R=2150.000	12.383	106.878	119.261	6160.000
TL=20	TL=20	11.901	107.235	119.136	6170.000
CL=27.817	CL=27.302	11.604	107.592	119.196	6180.000
		11.188	107.950	119.138	6190.000
		10.677	108.307	118.984	6200.000
		10.616	108.664	119.280	6210.000
		10.002	109.022	119.024	6220.000
		9.639	109.379	119.018	6230.000
		9.421	109.736	119.157	6240.000
		8.667	110.094	118.761	6250.000
		8.209	110.451	118.660	6260.000
		7.905	110.808	118.713	6270.000
		7.442	111.166	118.608	6280.000
		6.894	111.523	118.417	6290.000
		6.439	111.880	118.319	6300.000
		5.858	112.238	118.096	6310.000
		5.369	112.595	117.964	6320.000
		5.119	112.952	118.071	6330.000
		4.941	113.310	118.251	6340.000
		4.401	113.667	118.068	6350.000
		4.130	114.024	118.154	6360.000
		3.640	114.382	118.022	6370.000
		3.224	114.739	117.963	6380.000
		3.252	115.096	118.348	6390.000
		2.904	115.454	118.358	6400.000
		2.601	115.811	118.412	6410.000
		2.371	116.168	118.539	6420.000
		2.715	116.526	119.241	6430.000
		1.698	116.883	118.581	6440.000
		1.193	117.240	118.433	6450.000
		0.759	117.598	118.357	6460.000
		0.183	117.955	118.138	6470.000
		0.085	118.312	118.227	6480.000
		0.688	118.670	117.982	6490.000
		0.970	119.027	118.057	6500.000
		1.248	119.384	118.136	6510.000
		1.403	119.742	118.339	6520.000
		1.710	120.099	118.389	6530.000
		2.271	120.456	118.185	6540.000
		2.148	120.814	118.666	6550.000
		2.683	121.171	118.488	6560.000
		3.061	121.528	118.467	6570.000
		3.171	121.886	118.715	6580.000
		3.475	122.243	118.768	6590.000
		3.437	122.600	119.163	6600.000
		3.635	122.958	119.423	6610.000
		3.949	123.315	119.366	6620.000
		4.116	123.672	119.556	6630.000
		3.991	124.030	120.039	6640.000
		4.170	124.387	120.217	6650.000
		4.694	124.744	120.050	6660.000
		5.483	125.102	119.619	6670.000
		5.779	125.459	119.680	6680.000
		5.851	125.816	119.965	6690.000
				119.740	6700.000

GENERAL NOTES:

- ALL DIMENSIONS ARE IN MILLIMETER UNLESS MENTIONED.
- ALL DIMENSIONS ARE TO BE READ AND NOT MEASURED.
- ANY DISCREPANCY MUST BE BROUGHT TO THE NOTICE OF THE DMRC BEFORE EXECUTION OF WORK AT SITE.
- THIS DRAWING MUST BE READ IN CONJUNCTION WITH ALL RELEVANT ARCHITECTURAL, STRUCTURAL, PLUMBING & FIRE FIGHTING, ELECTRICAL AND TRAFFIC MANAGEMENT DRAWINGS.

REVISIONS

REV.	DESCRIPTION	DATE	DRAWN BY	CHECKED BY

APPROVAL OF LMRC OFFICIALS

Confirmed that this document has been designed and checked in accordance with DDC Quality Assurance Plan.

Authorised Signatory for DDC, LUCKNOW/DMRC Project Manager

Architecture Design In-charge/ Coordinator Structure Design In-charge/ Coordinator E&M Design In-charge/ Coordinator

DETAIL DESIGN CONSULTANT :

ayesa

Ayesa India Private Limited
D 99, 3rd Floor, Sector 2, Noida -201301, Gautam
Budh Nagar, Uttar Pradesh
Tel.: +(91) 120 490 8800, Email: delhi@ayesa.com

PROJECT TITLE:
UTTAR PRADESH METRO RAIL CORPORATION LTD.
(Formerly known as Lucknow Metro Rail Corporation Ltd.)

DRAWING TITLE:
GENERAL ALIGNMENT DRAWING - UP MAIN
CH: 6150.00 to 6700.00

NORTH	DRAWN BY:	CHECKED BY:	VERIFIED BY:	APPROVED BY:

ORDER N° DRAWING NUMBER: SHEET NO. 9 of 9 SHEET SIZE A1

This drawing must not be either loaned, copied or otherwise reproduced in whole or in part or used for any purpose without the prior written permission of LMRC.

GAUTAM BUDHA MARG STATION AT CH: 0+965.097m



GAUTAM BUDHA STATION

Ch. 0+965.097 m Level 100.500 m



CHAINAGE	EXISTING GROUND LEVEL	PROPOSED RAIL LEVEL	LEVEL DIFFERENCE	HORIZONTAL ALIGNMENT	VERTICAL ALIGNMENT
830.000	+21.477	+00.246	-21.231		
840.000	+21.452	+00.277	-21.175		
850.000	+21.394	+00.307	-21.087		
860.000	+21.415	+00.338	-21.077		
870.000	+21.418	+00.368	-21.050		
880.000	+21.422	+00.399	-21.023		
890.000	+21.428	+00.430	-20.998		
900.000	+21.409	+00.460	-20.949		
910.000	+21.631	+00.487	-21.144		
920.000	+21.360	+00.499	-20.861		
930.000	+21.200	+00.500	-20.700		
940.000	+20.997	+00.500	-20.497		
950.000	+20.717	+00.500	-20.217		
960.000	+20.653	+00.500	-20.153		
970.000	+20.700	+00.500	-20.200		
980.000	+20.932	+00.500	-20.432		
990.000	+21.197	+00.500	-20.697		
1000.000	+20.965	+00.500	-20.465		
1010.000	+20.937	+00.500	-20.437		
1020.000	+21.311	+00.500	-20.811		
1030.000	+20.343	+00.500	-19.843		
1040.000	+20.877	+00.500	-20.177		
1050.000	+20.567	+00.495	-20.072		
1060.000	+20.493	+00.478	-20.015		
1070.000	+20.707	+00.449	-20.258		
1080.000	+20.893	+00.419	-20.274		
1090.000	+20.834	+00.389	-20.445		
1100.000	+20.522	+00.359	-20.163		
1110.000	+20.558	+00.329	-20.229		
1120.000	+20.500	+00.299	-20.201		
1130.000	+20.615	+00.269	-20.346		
1140.000	+20.264	+00.239	-20.025		
1150.000	+20.186	+00.209	-19.977		
1160.000	+19.780	+00.179	-19.601		
1170.000	+19.805	+00.149	-19.656		
1180.000	+19.987	+00.119	-19.868		
1190.000	+19.820	+00.089	-19.731		
1200.000	+19.706	+00.059	-19.647		
1210.000	+20.179	+00.029	-20.150		
1220.000	+20.974	+00.999	-20.975		
1230.000	+19.705	+00.969	-19.736		
1240.000	+19.760	+00.939	-19.821		
1250.000	+19.632	+00.909	-19.723		
1260.000	+19.827	+00.879	-19.948		
1270.000	+19.706	+00.849	-19.857		
1280.000	+19.452	+00.819	-19.633		
1290.000	+19.789	+00.789	-20.000		
1300.000	+19.550	+00.759	-19.791		
1310.000	+19.585	+00.729	-19.856		
1320.000	+19.635	+00.699	-19.936		
1330.000	+19.594	+00.669	-19.925		
1340.000	+19.547	+00.639	-19.908		
1350.000	+19.164	+00.609	-19.555		
1360.000	+19.322	+00.579	-19.743		
1370.000	+19.384	+00.549	-19.835		
1380.000	+19.342	+00.519	-19.823		
1390.000	+19.175	+00.489	-19.686		
1400.000	+19.097	+00.459	-19.638		
1410.000	+18.894	+00.429	-19.465		
1420.000	+18.762	+00.399	-19.363		
1430.000	+18.935	+00.369	-19.561		
1440.000	+19.057	+00.339	-19.715		
1450.000	+19.128	+00.309	-19.817		
1460.000	+19.146	+00.279	-19.868		
1470.000	+19.113	+00.249	-19.866		
1480.000	+19.028	+00.220	-19.811		
1490.000	+18.891	+00.190	-19.697		
1500.000	+18.702	+00.160	-19.519		
1510.000	+18.462	+00.130	-19.277		
1520.000	+18.170	+00.100	-18.971		
1530.000	+17.828	+00.070	-18.604		
1540.000	+17.657	+00.040	-18.394		
1550.000	+17.869	+00.010	-18.379		
1560.000	+17.697	+00.010	-18.380		
1570.000	+17.742	+00.010	-18.399		
1580.000	+17.802	+00.010	-18.432		
1590.000	+17.879	+00.010	-18.482		

GENERAL NOTES:
 1. ALL DIMENSIONS ARE IN MILLIMETER UNLESS MENTIONED.
 2. ALL DIMENSIONS ARE TO BE READ AND NOT MEASURED.
 3. ANY DISCREPANCY MUST BE BROUGHT TO THE NOTICE OF THE DMRC BEFORE EXECUTION OF WORK AT SITE.
 4. THIS DRAWING MUST BE READ IN CONJUNCTION WITH ALL RELEVANT ARCHITECTURAL, STRUCTURAL, PLUMBING & FIRE FIGHTING, ELECTRICAL AND TRAFFIC MANAGEMENT DRAWINGS.

REVISION	REFERENCE DRAWINGS	DESCRIPTION	DRAWING NO.

REV.	DESCRIPTION	DATE	DRAWN BY	CHECKED BY

APPROVAL OF LMRC OFFICIALS	

Certified that this document has been designed and checked in accordance with DDC Quality Assurance Plan.

Architecture Design In-charge/ Coordinator: _____
 Structure Design In-charge/ Coordinator: _____
 E&M Design In-charge/ Coordinator: _____

DETAIL DESIGN CONSULTANT : **ayesa**

Ayesa India Private Limited
 D 99, 3rd Floor, Sector 2, Noida -201301, Gautam Budh Nagar, Uttar Pradesh
 Tel.: +(91) 120 490 8800, Email: delhi@ayesa.com

PROJECT TITLE: **UTTAR PRADESH METRO RAIL CORPORATION LTD.**
 (Formerly known as Lucknow Metro Rail Corporation Ltd.)

DRAWING TITLE: **GENERAL ALIGNMENT DRAWING - DN MAIN**
 CH: 830.00 to 1590.00

NORTH	DRAWN BY:	CHECKED BY:	VERIFIED BY:	APPROVED BY:

ORDER N°: _____ DRAWING NUMBER: _____ SHEET NO. 2 of 9 SHEET SIZE: A1

DDC

THIS DRAWING IS THE PROPERTY OF LUCKNOW METRO RAIL CORPORATION LTD.

This drawing must not be either loaned, copied or otherwise reproduced in whole or in part or used for any purpose without the prior written permission of LMRC.

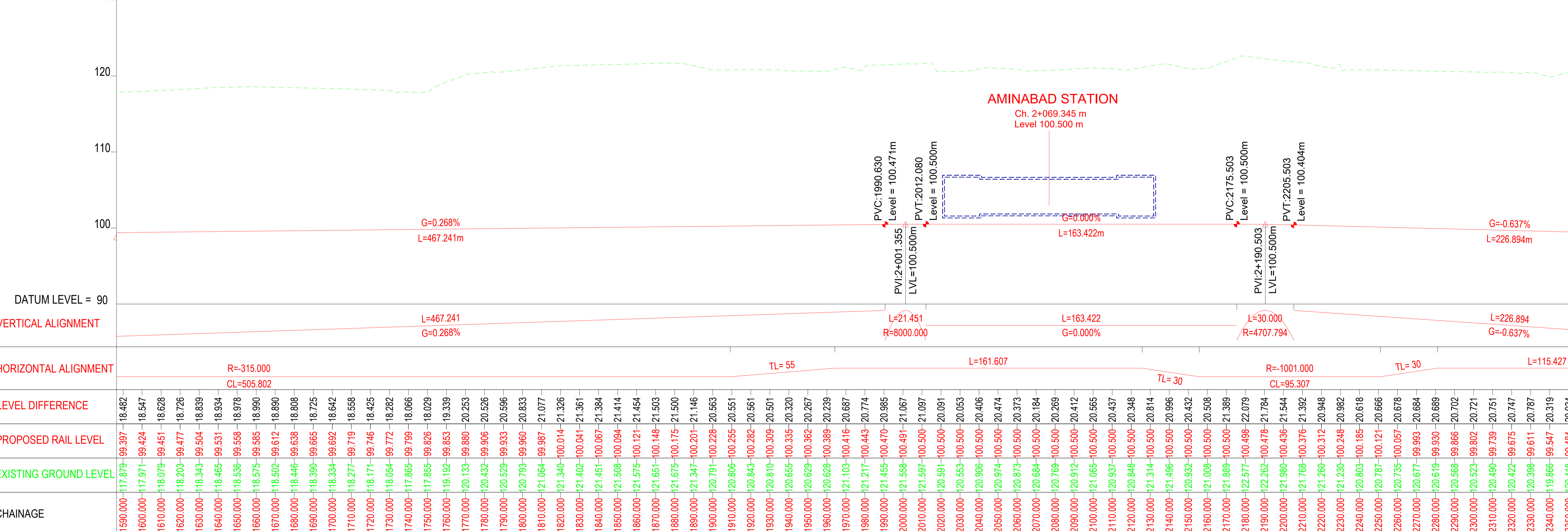
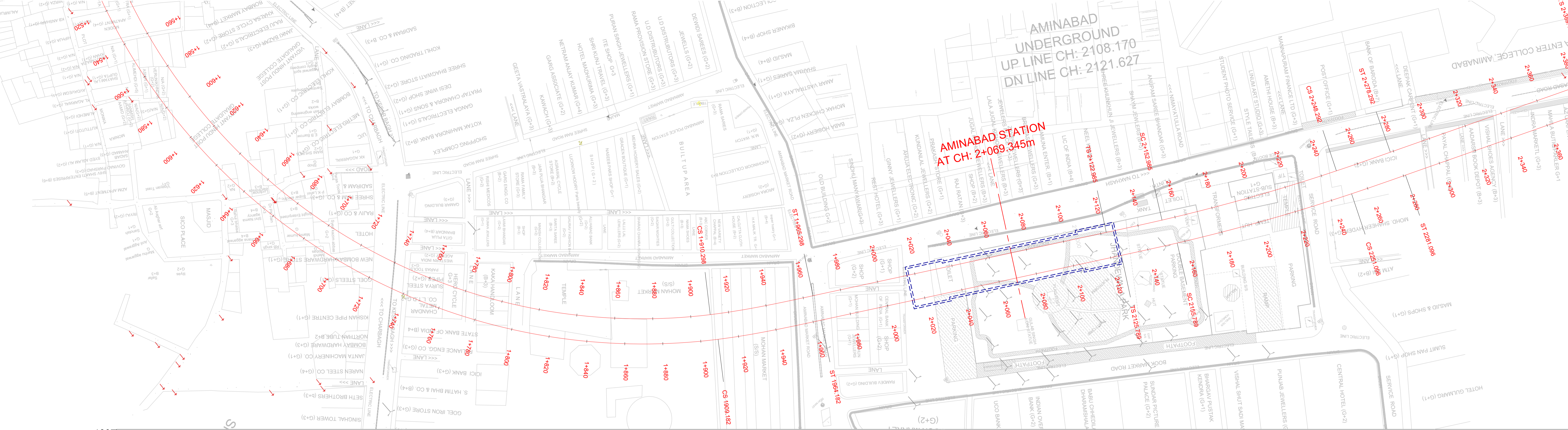

GENERAL NOTES:

1. ALL DIMENSIONS ARE IN MILLIMETER UNLESS MENTIONED.
2. ALL DIMENSIONS ARE TO BE READ AND NOT MEASURED.
3. ANY DISCREPANCY MUST BE BROUGHT TO THE NOTICE OF THE DMRC BEFORE EXECUTION OF WORK AT SITE.
4. THIS DRAWING MUST BE READ IN CONJUNCTION WITH ALL RELEVANT ARCHITECTURAL, STRUCTURAL, PLUMBING & FIRE FIGHTING, ELECTRICAL AND TRAFFIC MANAGEMENT DRAWINGS.

REVISION	DESCRIPTION	DRAWING NO.

REV.	DESCRIPTION	DATE	DRAWN BY	CHECKED BY

APPROVAL OF LMRC OFFICIALS	

Certified that this document has been designed and checked in accordance with DDC Quality Assurance Plan.

Architecture Design In-charge/ Coordinator: **ayesa**

Structure Design In-charge/ Coordinator: **ayesa**

E&M Design In-charge/ Coordinator: **ayesa**

DETAIL DESIGN CONSULTANT : **ayesa**

Ayesa India Private Limited
D 99, 3rd Floor, Sector 2, Noida -201301,Gautam Budh Nagar, Uttar Pradesh
Tel.: +(91) 120 490 8800, Email: delhi@ayesa.com

PROJECT TITLE: **UTTAR PRADESH METRO RAIL CORPORATION LTD.**
(Formerly known as Lucknow Metro Rail Corporation Ltd.)

DRAWING TITLE: **GENERAL ALIGNMENT DRAWING - DN MAIN**
CH: 1590.00 to 2350.00

NORTH	DRAWN BY:	CHECKED BY:	VERIFIED BY:	APPROVED BY:

ORDER NO: **3 of 9**

SHEET NO: **3 of 9**

SHEET SIZE: **A1**

DDC

This drawing must not be either loaned, copied or otherwise reproduced in whole or in part or used for any purpose without the prior written permission of LMRC.

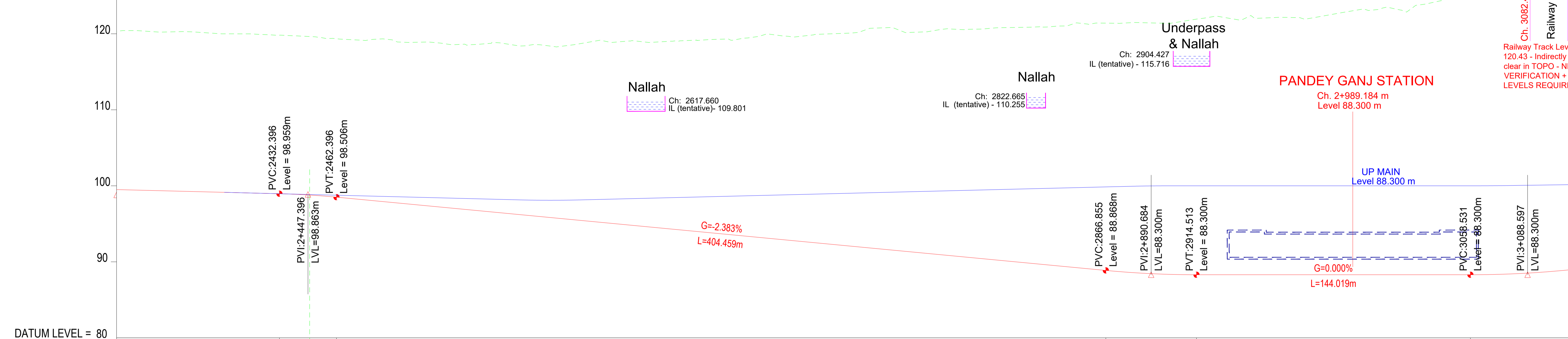

CHAINAGE	EXISTING GROUND LEVEL	PROPOSED RAIL LEVEL	LEVEL DIFFERENCE	HORIZONTAL ALIGNMENT	VERTICAL ALIGNMENT
2350.000	20.418	99.484	20.934		
2360.000	20.377	99.420	20.957		
2370.000	20.220	99.356	20.864		
2380.000	20.276	99.292	20.987		
2390.000	20.200	99.229	20.971		
2400.000	20.103	99.165	20.866		
2410.000	19.999	99.101	20.893		
2420.000	19.947	99.038	20.905		
2430.000	19.820	98.974	20.846		
2440.000	19.739	98.893	20.846		
2450.000	19.618	98.756	20.862		
2460.000	19.397	98.561	20.836		
2470.000	19.228	98.324	20.904		
2480.000	19.124	98.086	21.126		
2490.000	19.248	97.848	21.400		
2500.000	18.867	97.609	21.258		
2510.000	18.917	97.371	21.546		
2520.000	18.669	97.133	21.536		
2530.000	18.611	96.895	21.716		
2540.000	18.679	96.656	22.023		
2550.000	18.739	96.418	22.321		
2560.000	18.401	96.180	22.221		
2570.000	18.537	95.941	22.596		
2580.000	18.337	95.703	22.634		
2590.000	18.681	95.465	23.216		
2600.000	19.112	95.227	23.885		
2610.000	18.927	94.988	23.939		
2620.000	19.049	94.750	24.293		
2630.000	18.906	94.512	24.394		
2640.000	19.055	94.273	24.782		
2650.000	19.150	94.035	25.115		
2660.000	19.256	93.797	25.459		
2670.000	19.151	93.559	25.592		
2680.000	19.501	93.320	26.181		
2690.000	19.950	93.082	26.868		
2700.000	19.668	92.844	26.824		
2710.000	19.770	92.605	27.165		
2720.000	19.975	92.367	27.608		
2730.000	20.066	92.129	27.940		
2740.000	20.473	91.891	28.582		
2750.000	20.790	91.652	29.138		
2760.000	20.303	91.414	28.889		
2770.000	20.237	91.176	29.061		
2780.000	20.567	90.937	29.630		
2790.000	20.570	90.699	29.871		
2800.000	20.617	90.461	30.156		
2810.000	20.796	90.223	30.573		
2820.000	20.838	89.984	30.854		
2830.000	20.899	89.746	31.153		
2840.000	20.983	89.508	31.475		
2850.000	21.326	89.269	32.057		
2860.000	21.340	89.031	32.309		
2870.000	21.393	88.795	32.598		
2880.000	21.463	88.558	32.865		
2890.000	21.437	88.450	32.987		
2900.000	21.374	88.353	33.021		
2910.000	21.752	88.305	33.447		
2920.000	22.123	88.300	33.823		
2930.000	22.112	88.300	33.812		
2940.000	22.028	88.300	33.728		
2950.000	22.076	88.300	33.776		
2960.000	22.161	88.300	33.864		
2970.000	22.029	88.300	33.729		
2980.000	22.294	88.300	33.994		
2990.000	22.740	88.300	34.440		
3000.000	23.168	88.300	34.866		
3010.000	23.197	88.300	34.897		
3020.000	23.222	88.300	34.921		
3030.000	23.750	88.300	35.450		
3040.000	24.189	88.300	35.889		
3050.000	24.797	88.300	36.497		
3060.000	24.665	88.301	36.384		
3070.000	25.099	88.331	36.769		
3080.000	25.281	88.410	36.871		
3090.000	25.791	88.536	37.255		
3100.000	25.552	88.709	36.843		
3110.000	25.434	88.931	36.503		

GENERAL NOTES:
 1. ALL DIMENSIONS ARE IN MILLIMETER UNLESS MENTIONED.
 2. ALL DIMENSIONS ARE TO BE READ AND NOT MEASURED.
 3. ANY DISCREPANCY MUST BE BROUGHT TO THE NOTICE OF THE DMRC BEFORE EXECUTION OF WORK AT SITE.
 4. THIS DRAWING MUST BE READ IN CONJUNCTION WITH ALL RELEVANT ARCHITECTURAL, STRUCTURAL, PLUMBING & FIRE FIGHTING, ELECTRICAL AND TRAFFIC MANAGEMENT DRAWINGS.

REVISION	REFERENCE DRAWINGS	DESCRIPTION	DRAWING NO.

REV.	DESCRIPTION	DATE	DRAWN BY	CHECKED BY

APPROVAL OF LMRC OFFICIALS				

Certified that this document has been designed and checked in accordance with DDC Quality Assurance Plan.

Architecture Design In-charge/ Coordinator: _____
 Structure Design In-charge/ Coordinator: _____
 E&M Design In-charge/ Coordinator: _____

Authorized Signatory for DDC, LUCKNOWDDC Project Manager: _____

DETAIL DESIGN CONSULTANT : **ayesa**
 Ayesa India Private Limited
 D 99, 3rd Floor, Sector 2, Noida -201301, Gautam Budh Nagar, Uttar Pradesh
 Tel.: +(91) 120 490 8800, Email: delhi@ayesa.com

PROJECT TITLE: **UTTAR PRADESH METRO RAIL CORPORATION LTD.**
 (Formerly known as Lucknow Metro Rail Corporation Ltd.)

DRAWING TITLE: **GENERAL ALIGNMENT DRAWING - DN MAIN**
 CH: 2350.00 to 3010.00

NORTH	DRAWN BY:	CHECKED BY:	VERIFIED BY:	APPROVED BY:

ORDER N°: _____ DRAWING NUMBER: _____ SHEET NO. 4 of 9 SHEET SIZE A1

Scale: _____ Status: _____

DDC

Ch. 3082.4
 Railway
 Ch. 3102.4
 Railway Track Level 120.43 - Indirectly V clear in TOPO - NEI VERIFICATION + E LEVELS REQUIRED

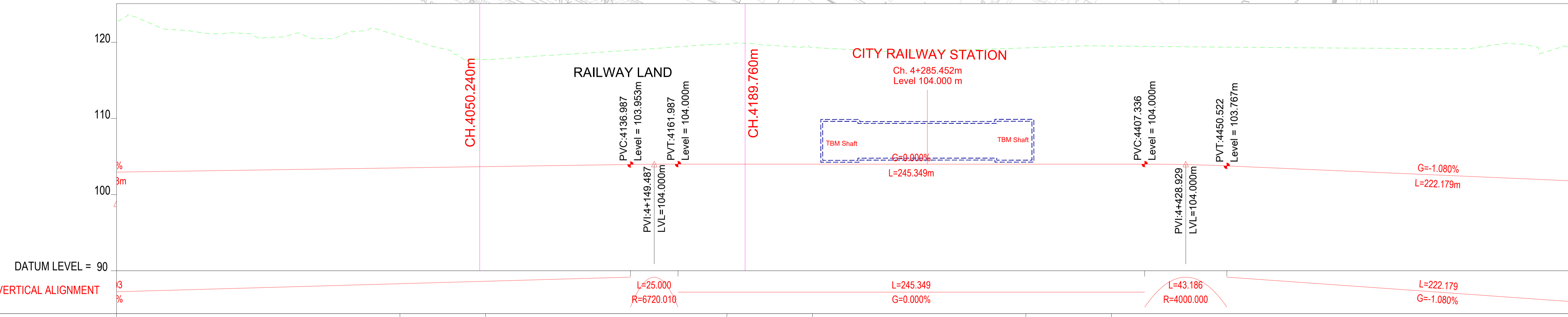
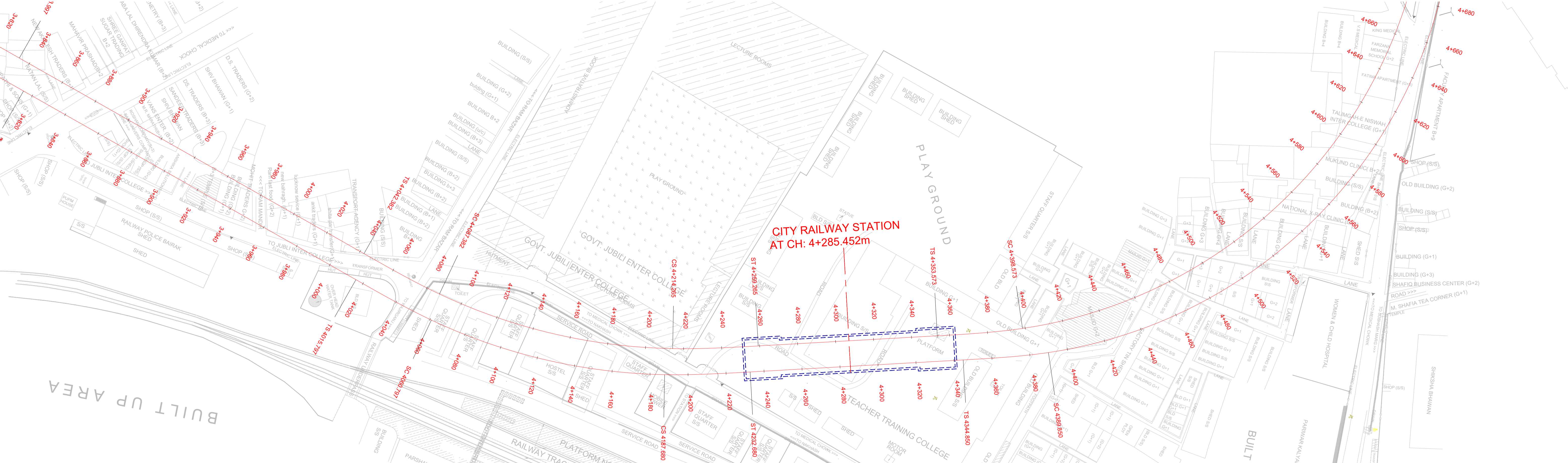

CHAINAGE	PROPOSED RAIL LEVEL	EXISTING GROUND LEVEL	LEVEL DIFFERENCE	HORIZONTAL ALIGNMENT	VERTICAL ALIGNMENT
3870.000	+102.960	+123.108	-20.148	L=200.981	3%
3880.000	+102.997	+122.969	-19.972		
3890.000	+103.035	+121.904	-18.869		
3900.000	+103.072	+121.603	-18.531		
3910.000	+103.109	+121.311	-18.202		
3920.000	+103.146	+121.123	-17.977		
3930.000	+103.183	+121.209	-18.026		
3940.000	+103.221	+120.726	-17.505		
3950.000	+103.258	+120.667	-17.409		
3960.000	+103.295	+121.090	-17.795		
3970.000	+103.332	+120.529	-17.197		
3980.000	+103.369	+120.453	-17.084		
3990.000	+103.407	+121.439	-18.032		
4000.000	+103.444	+121.783	-18.339		
4010.000	+103.481	+121.243	-17.762		
4020.000	+103.518	+120.474	-16.956		
4030.000	+103.555	+119.703	-16.148		
4040.000	+103.593	+119.090	-15.497		
4050.000	+103.630	+117.622	-13.992		
4060.000	+103.667	+117.736	-14.069		
4070.000	+103.704	+117.852	-14.148		
4080.000	+103.741	+118.022	-14.281		
4090.000	+103.779	+118.217	-14.438		
4100.000	+103.816	+118.364	-14.548		
4110.000	+103.853	+118.517	-14.664		
4120.000	+103.890	+118.676	-14.786		
4130.000	+103.928	+118.840	-14.912		
4140.000	+103.964	+119.011	-15.047		
4150.000	+103.989	+119.186	-15.197		
4160.000	+104.000	+119.367	-15.367		
4170.000	+104.000	+119.552	-15.552		
4180.000	+104.000	+119.699	-15.699		
4190.000	+104.000	+119.767	-15.767		
4200.000	+104.000	+119.833	-15.833		
4210.000	+104.000	+119.605	-15.605		
4220.000	+104.000	+119.448	-15.448		
4230.000	+104.000	+119.492	-15.492		
4240.000	+104.000	+119.208	-15.208		
4250.000	+104.000	+119.077	-15.077		
4260.000	+104.000	+118.946	-14.946		
4270.000	+104.000	+118.815	-14.815		
4280.000	+104.000	+118.694	-14.694		
4290.000	+104.000	+118.782	-14.782		
4300.000	+104.000	+118.870	-14.870		
4310.000	+104.000	+118.958	-14.958		
4320.000	+104.000	+119.046	-15.046		
4330.000	+104.000	+119.134	-15.134		
4340.000	+104.000	+119.222	-15.222		
4350.000	+104.000	+119.310	-15.310		
4360.000	+104.000	+119.397	-15.397		
4370.000	+104.000	+119.483	-15.483		
4380.000	+104.000	+119.534	-15.534		
4390.000	+104.000	+119.507	-15.507		
4400.000	+104.000	+119.480	-15.480		
4410.000	+103.999	+119.454	-15.455		
4420.000	+103.980	+119.429	-15.449		
4430.000	+103.936	+119.405	-15.469		
4440.000	+103.867	+119.381	-15.514		
4450.000	+103.772	+119.359	-15.587		
4460.000	+103.665	+119.337	-15.672		
4470.000	+103.557	+119.316	-15.759		
4480.000	+103.449	+119.296	-15.847		
4490.000	+103.341	+119.277	-15.936		
4500.000	+103.233	+119.259	-16.026		
4510.000	+103.125	+119.242	-16.117		
4520.000	+103.017	+119.226	-16.209		
4530.000	+102.909	+119.211	-16.302		
4540.000	+102.801	+119.197	-16.396		
4550.000	+102.693	+119.185	-16.492		
4560.000	+102.585	+119.173	-16.588		
4570.000	+102.477	+119.163	-16.686		
4580.000	+102.369	+119.239	-16.870		
4590.000	+102.261	+119.612	-17.351		
4600.000	+102.153	+119.881	-17.728		
4610.000	+102.045	+119.555	-17.510		
4620.000	+101.937	+118.876	-16.939		
4630.000	+101.829	+119.464	-17.635		

GENERAL NOTES:

- ALL DIMENSIONS ARE IN MILLIMETER UNLESS MENTIONED.
- ALL DIMENSIONS ARE TO BE READ AND NOT MEASURED.
- ANY DISCREPANCY MUST BE BROUGHT TO THE NOTICE OF THE DMRC BEFORE EXECUTION OF WORK AT SITE.
- THIS DRAWING MUST BE READ IN CONJUNCTION WITH ALL RELEVANT ARCHITECTURAL, STRUCTURAL, PLUMBING & FIRE FIGHTING, ELECTRICAL AND TRAFFIC MANAGEMENT DRAWINGS.

REVISIONS

REV.	DESCRIPTION	DATE	DRAWN BY	CHECKED BY

APPROVAL OF LMRC OFFICIALS

Certified that this document has been designed and checked in accordance with DDC Quality Assurance Plan.

Authorised Signatory for DDC, LUCKNOWDDC Project Manager

Architecture Design In-charge/ Coordinator Structure Design In-charge/ Coordinator E&M Design In-charge/ Coordinator

DETAIL DESIGN CONSULTANT :

ayesa

Ayesa India Private Limited
D 99, 3rd Floor, Sector 2, Noida -201301, Gautam
Budh Nagar, Uttar Pradesh
Tel.: +(91) 120 490 8800, Email: delhi@ayesa.com

PROJECT TITLE:
UTTAR PRADESH METRO RAIL CORPORATION LTD.
(Formerly known as Lucknow Metro Rail Corporation Ltd.)

DRAWING TITLE:
GENERAL ALIGNMENT DRAWING - DN MAIN
CH: 3870.00 TO 4630.00

NORTH	DRAWN BY:	CHECKED BY:	VERIFIED BY:	APPROVED BY:
DATE:	REV:	SCALE:	STATUS:	DDC
ORDER N°	DRAWING NUMBER:	SHEET NO. 6 of 9	SHEET SIZE A1	

This drawing must not be either loaned, copied or otherwise reproduced in whole or in part or used for any purpose without the prior written permission of LMRC.

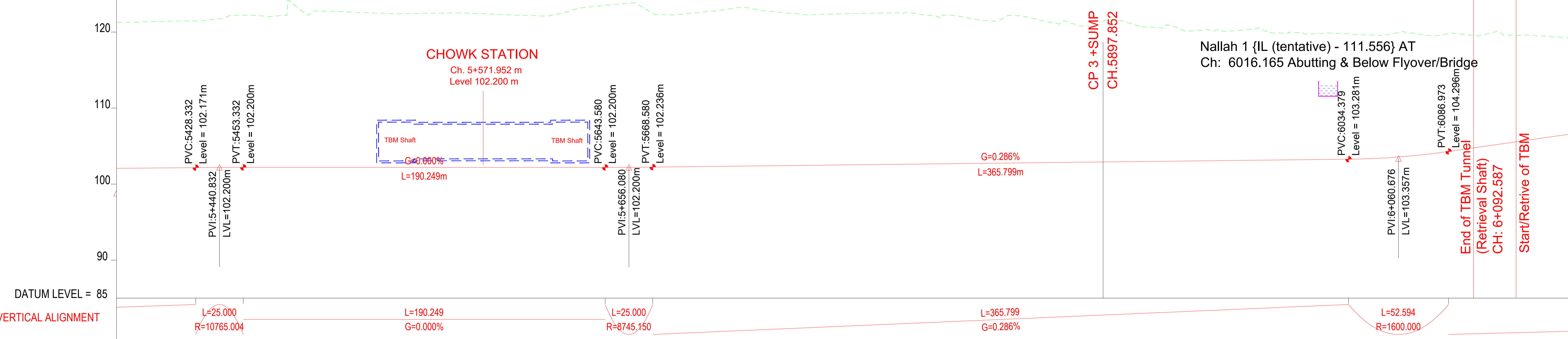
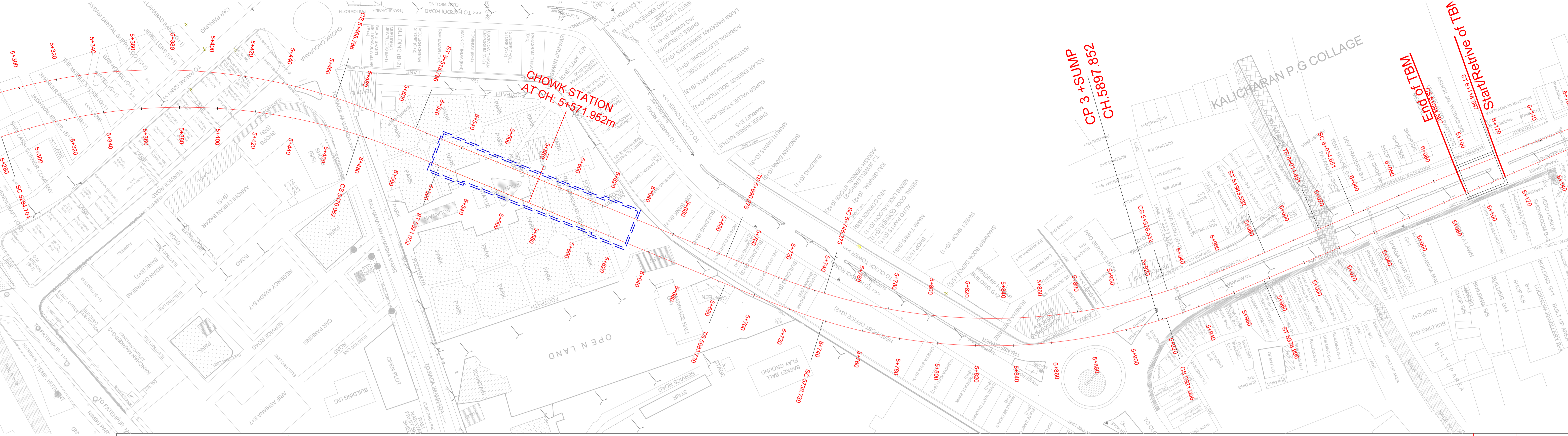

VERTICAL ALIGNMENT	HORIZONTAL ALIGNMENT	LEVEL DIFFERENCE	PROPOSED RAIL LEVEL	EXISTING GROUND LEVEL	CHAINAGE
L=25.000 R=10765.004	TL=45	19.199	5390.000	+21.281	5390.000
L=190.249 G=0.000%	L=162.687	19.233	5400.000	+21.338	5400.000
L=25.000 R=8745.150	TL=55	19.274	5410.000	+21.402	5410.000
L=365.799 G=0.286%	R=300.000 CL=183.257	19.298	5420.000	+21.450	5420.000
L=52.594 R=1600.000	TL=55	19.309	5430.000	+21.484	5430.000
		19.543	5440.000	+21.735	5440.000
		19.999	5450.000	+22.198	5450.000
		19.971	5460.000	+22.171	5460.000
		19.900	5470.000	+22.100	5470.000
		21.414	5480.000	+23.614	5480.000
		20.511	5490.000	+22.711	5490.000
		20.519	5500.000	+22.719	5500.000
		20.430	5510.000	+22.630	5510.000
		20.327	5520.000	+22.527	5520.000
		20.222	5530.000	+22.422	5530.000
		20.234	5540.000	+22.434	5540.000
		20.288	5550.000	+22.488	5550.000
		20.301	5560.000	+22.501	5560.000
		20.305	5570.000	+22.505	5570.000
		20.221	5580.000	+22.421	5580.000
		20.100	5590.000	+22.300	5590.000
		20.011	5600.000	+22.211	5600.000
		19.922	5610.000	+22.122	5610.000
		20.248	5620.000	+22.448	5620.000
		20.963	5630.000	+23.163	5630.000
		21.221	5640.000	+23.421	5640.000
		21.473	5650.000	+23.673	5650.000
		21.514	5660.000	+23.729	5660.000
		20.104	5670.000	+22.344	5670.000
		20.004	5680.000	+22.272	5680.000
		20.216	5690.000	+22.513	5690.000
		20.427	5700.000	+22.753	5700.000
		20.735	5710.000	+23.089	5710.000
		20.740	5720.000	+23.123	5720.000
		20.323	5730.000	+22.734	5730.000
		20.063	5740.000	+22.503	5740.000
		19.805	5750.000	+22.273	5750.000
		19.852	5760.000	+22.349	5760.000
		19.888	5770.000	+22.414	5770.000
		19.915	5780.000	+22.469	5780.000
		19.931	5790.000	+22.514	5790.000
		19.823	5800.000	+22.434	5800.000
		19.680	5810.000	+22.320	5810.000
		19.193	5820.000	+21.862	5820.000
		19.364	5830.000	+22.061	5830.000
		18.869	5840.000	+21.595	5840.000
		18.690	5850.000	+21.444	5850.000
		19.369	5860.000	+22.152	5860.000
		18.912	5870.000	+21.724	5870.000
		18.329	5880.000	+21.169	5880.000
		18.203	5890.000	+21.072	5890.000
		17.873	5900.000	+20.770	5900.000
		18.713	5910.000	+21.639	5910.000
		18.171	5920.000	+21.125	5920.000
		17.664	5930.000	+20.647	5930.000
		17.903	5940.000	+20.915	5940.000
		17.100	5950.000	+20.140	5950.000
		17.240	5960.000	+20.309	5960.000
		17.020	5970.000	+20.117	5970.000
		17.178	5980.000	+20.304	5980.000
		17.078	5990.000	+20.233	5990.000
		16.677	6000.000	+19.860	6000.000
		16.690	6010.000	+19.902	6010.000
		16.566	6020.000	+19.806	6020.000
		16.549	6030.000	+19.818	6030.000
		16.359	6040.000	+19.666	6040.000
		16.181	6050.000	+19.583	6050.000
		16.345	6060.000	+19.905	6060.000
		16.008	6070.000	+19.788	6070.000
		15.440	6080.000	+19.502	6080.000
		15.426	6090.000	+19.830	6090.000
		14.791	6100.000	+19.553	6100.000
		14.818	6110.000	+19.937	6110.000
		14.115	6120.000	+19.591	6120.000
		13.751	6130.000	+19.585	6130.000
		13.265	6140.000	+19.456	6140.000
		12.681	6150.000	+19.229	6150.000

GENERAL NOTES:
 1. ALL DIMENSIONS ARE IN MILLIMETER UNLESS MENTIONED.
 2. ALL DIMENSIONS ARE TO BE READ AND NOT MEASURED.
 3. ANY DISCREPANCY MUST BE BROUGHT TO THE NOTICE OF THE DMRC BEFORE EXECUTION OF WORK AT SITE.
 4. THIS DRAWING MUST BE READ IN CONJUNCTION WITH ALL RELEVANT ARCHITECTURAL, STRUCTURAL, PLUMBING & FIRE FIGHTING, ELECTRICAL AND TRAFFIC MANAGEMENT DRAWINGS.

REVISION	DESCRIPTION	DRAWING NO.

REV.	DESCRIPTION	DATE	DRAWN BY	CHECKED BY

APPROVAL OF LMRC OFFICIALS

Certified that this document has been designed and checked in accordance with DDC Quality Assurance Plan.

Architecture Design In-charge/ Coordinator: _____
 Structure Design In-charge/ Coordinator: _____
 E&M Design In-charge/ Coordinator: _____

DETAIL DESIGN CONSULTANT : **ayesa**

Ayesa India Private Limited
 D 99, 3rd Floor, Sector 2, Noida -201301, Gautam Budh Nagar, Uttar Pradesh
 Tel.: +(91) 120 490 8800, Email: delhi@ayesa.com

PROJECT TITLE: **UTTAR PRADESH METRO RAIL CORPORATION LTD.**
 (Formerly known as Lucknow Metro Rail Corporation Ltd.)

DRAWING TITLE: **GENERAL ALIGNMENT DRAWING - DN MAIN**
 CH: 5390.00 to 6150.00

NORTH	DRAWN BY:	CHECKED BY:	VERIFIED BY:	APPROVED BY:
DATE:	REV:	SCALE:	STATUS:	DDC
ORDER N°	DRAWING NUMBER:	SHEET NO. 8 of 9	SHEET SIZE A1	

This drawing must not be either loaned, copied or otherwise reproduced in whole or in part or used for any purpose without the prior written permission of LMRC.

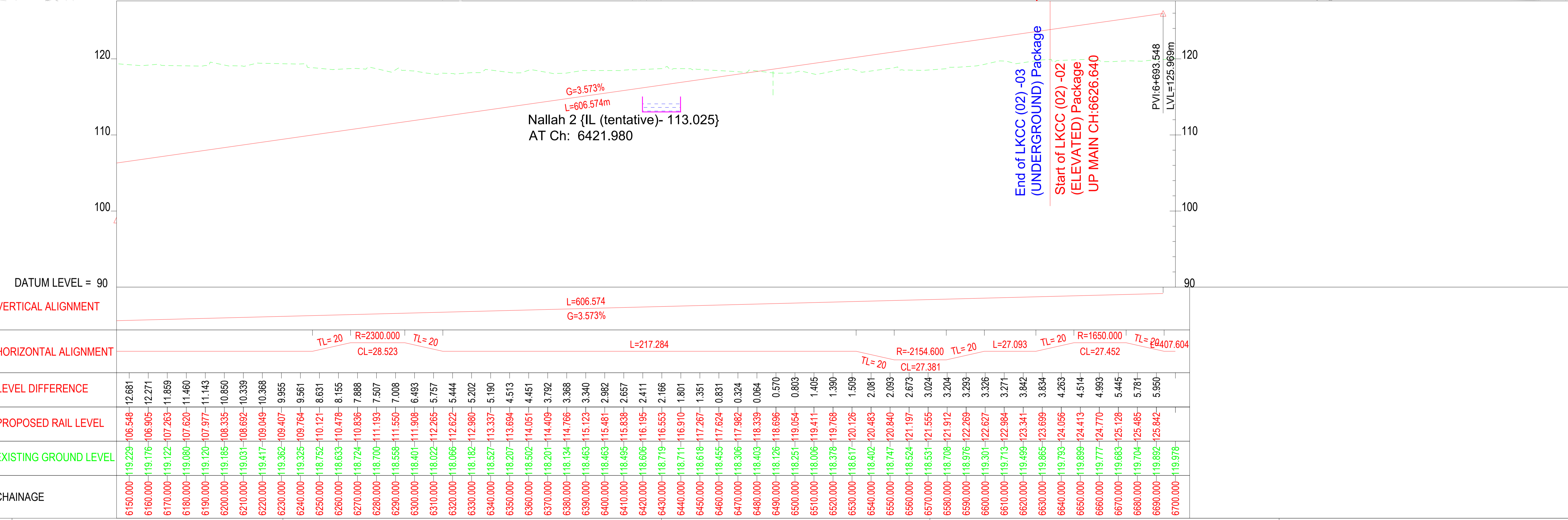
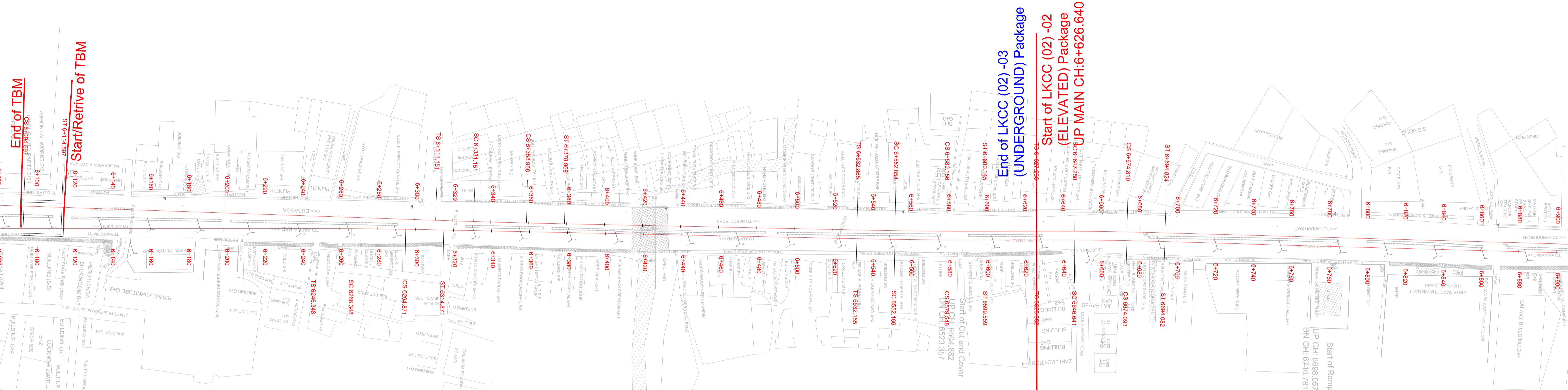

REVISION	DESCRIPTION	DRAWING NO.

REV.	DESCRIPTION	DATE	DRAWN BY	CHECKED BY

CHAINAGE	EXISTING GROUND LEVEL	PROPOSED RAIL LEVEL	LEVEL DIFFERENCE	HORIZONTAL ALIGNMENT	VERTICAL ALIGNMENT
6150.000	-119.229	+06.548	12.681	TL=20 R=2300.000 TL=20 CL=28.523	L=606.574 G=3.573%
6160.000	-119.176	+06.905	12.271		
6170.000	-119.122	+07.263	11.859		
6180.000	-119.068	+07.620	11.460		
6190.000	-119.120	+07.977	11.143		
6200.000	-119.185	+08.335	10.850		
6210.000	-119.031	+08.692	10.339		
6220.000	-119.417	+09.049	10.368		
6230.000	-119.362	+09.407	9.955		
6240.000	-119.325	+09.764	9.561		
6250.000	-118.752	+10.121	8.631		
6260.000	-118.633	+10.478	8.155		
6270.000	-118.724	+10.836	7.888		
6280.000	-118.700	+11.193	7.507		
6290.000	-118.558	+11.550	7.008		
6300.000	-118.401	+11.908	6.493		
6310.000	-118.022	+12.265	5.757		
6320.000	-118.066	+12.622	5.444		
6330.000	-118.182	+12.980	5.202		
6340.000	-118.527	+13.337	5.190		
6350.000	-118.207	+13.694	4.513		
6360.000	-118.502	+14.051	4.451		
6370.000	-118.201	+14.409	3.792		
6380.000	-118.134	+14.766	3.368		
6390.000	-118.463	+15.123	3.340		
6400.000	-118.463	+15.481	2.982		
6410.000	-118.495	+15.838	2.657		
6420.000	-118.606	+16.195	2.411		
6430.000	-118.719	+16.553	2.166		
6440.000	-118.711	+16.910	1.801		
6450.000	-118.618	+17.267	1.351		
6460.000	-118.455	+17.624	0.831		
6470.000	-118.306	+17.982	0.324		
6480.000	-118.403	+18.339	0.064		
6490.000	-118.126	+18.696	0.570		
6500.000	-118.251	+19.054	0.803		
6510.000	-118.006	+19.411	1.405		
6520.000	-118.378	+19.768	1.390		
6530.000	-118.617	+20.126	1.509		
6540.000	-118.402	+20.483	2.081		
6550.000	-118.747	+20.840	2.093		
6560.000	-118.524	+21.197	2.673		
6570.000	-118.531	+21.555	3.024		
6580.000	-118.708	+21.912	3.204		
6590.000	-118.976	+22.269	3.293		
6600.000	-119.301	+22.627	3.326		
6610.000	-119.713	+22.984	3.271		
6620.000	-119.499	+23.341	3.842		
6630.000	-119.865	+23.699	3.834		
6640.000	-119.793	+24.056	4.263		
6650.000	-119.899	+24.413	4.514		
6660.000	-119.777	+24.770	4.993		
6670.000	-119.683	+25.128	5.445		
6680.000	-119.704	+25.485	5.781		
6690.000	-119.892	+25.842	5.950		
6700.000	-119.978				

GENERAL NOTES:
 1. ALL DIMENSIONS ARE IN MILLIMETER UNLESS MENTIONED.
 2. ALL DIMENSIONS ARE TO BE READ AND NOT MEASURED.
 3. ANY DISCREPANCY MUST BE BROUGHT TO THE NOTICE OF THE DMRC BEFORE EXECUTION OF WORK AT SITE.
 4. THIS DRAWING MUST BE READ IN CONJUNCTION WITH ALL RELEVANT ARCHITECTURAL, STRUCTURAL, PLUMBING & FIRE FIGHTING, ELECTRICAL AND TRAFFIC MANAGEMENT DRAWINGS.

REV.	DESCRIPTION	DATE	DRAWN BY	CHECKED BY

APPROVAL OF LMRC OFFICIALS

Confirmed that this document has been designed and checked in accordance with DDC Quality Assurance Plan.

Architecture Design In-charge/ Coordinator
 Structure Design In-charge/ Coordinator
 E&M Design In-charge/ Coordinator

Authorised Signatory for DDC, LUCKNOWDDC Project Manager

DETAIL DESIGN CONSULTANT : **ayesa**

Ayesa India Private Limited
 D 99, 3rd Floor, Sector 2, Noida -201301, Gautam Budh Nagar, Uttar Pradesh
 Tel.: +(91) 120 490 8800, Email: delhi@ayesa.com

PROJECT TITLE: **UTTAR PRADESH METRO RAIL CORPORATION LTD.**
 (Formerly know as Lucknow Metro Rail Corporation Ltd.)

DRAWING TITLE: **GENERAL ALIGNMENT DRAWING - DN MAIN**
 CH: 6150.00 to 6700.00

NORTH	DRAWN BY:	CHECKED BY:	VERIFIED BY:	APPROVED BY:
	DATE:	REV:	SCALE:	STATUS:
ORDER N°	DRAWING NUMBER:	SHEET NO.	SHEET SIZE	DDC
		9 of 9	A1	

This drawing must not be either loaned, copied or otherwise reproduced in whole or in part or used for any purpose without the prior written permission of LMRC.